



**KZ1000-S1**

**Chassis  
Parts List**

# INDEX

FIG NO.	MAIN TITLE	PAGE
1.	FRAME .....	1
2.	FRAME FITTING .....	2
3.	STEP .....	3
4.	OIL COOLER FITTING .....	4
5.	SWING ARM, OIL CATCH TANK .....	5
6.	SHOCK ABSORBER .....	6
7.	FENDER .....	7
8.	FRONT HUB .....	8
9.	REAR HUB .....	9
10.	DRIVE CHAIN .....	10
11.	FRONT BRAKE .....	11
12.	REAR BRAKE .....	12
13.	HANDLEBAR .....	13
14.	FRONT FORK .....	14
15.	STEERING .....	15
16.	SHOCK ABSORBER STEERING .....	16
17.	FUEL TANK .....	17
18.	SEAT .....	18
19.	METER .....	19
20.	CABLE .....	20
21.	FAIRING .....	21
22.	NUMBER PLATE .....	22
23.	SIDE COVER .....	23
24.	GEAR CHANGE MECHANISM .....	24
25.	ELECTRICAL EQUIPMENT FITTING .....	25

**1. Frame**

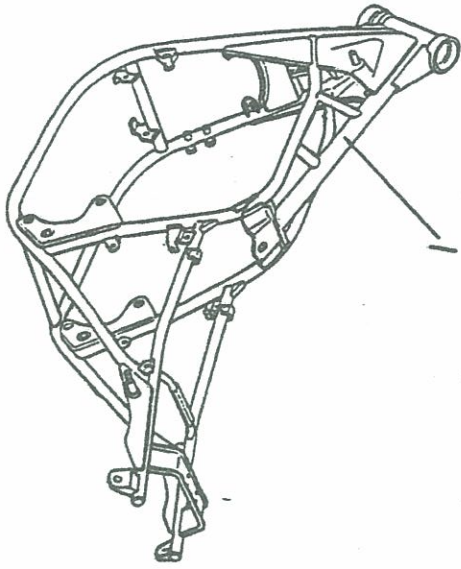

Ref. No.	Part No.	Description	Spec Code	Quantity - KZ1000					
				'92					
'1	BGF110-000-A	FRAME-COMP		1					

**2. Frame Fitting**

Ref. No. Part No. Description Spec. Call

1	92091-022	BOLT, 10 X 310	
2	92019-004	NUT, LOCK, 10MM	
3	41081000	WASHER-PLANE-SMALL, 8MM	
4	92001-1373	BOLT, 10 X 155	
5	92001-1372	BOLT, 12 X 283	
6	92016-1063	NUT, LOCK, 12MM	
*7	BGF132-010	BRACKET-ENGINE, FR, UPP	
*8	Y120P0885	BOLT, 8 X 65	
9	92016-1124	NUT, LOCK, 8MM	
10	41080900	WASHER-PLANE-SMALL, 8MM	
11	32029-1143	BRACKET-ENGINE, RR, RH	
*12	Y120P0940	BOLT, 8 X 40	
*13	BGF132-750	COLLAR	

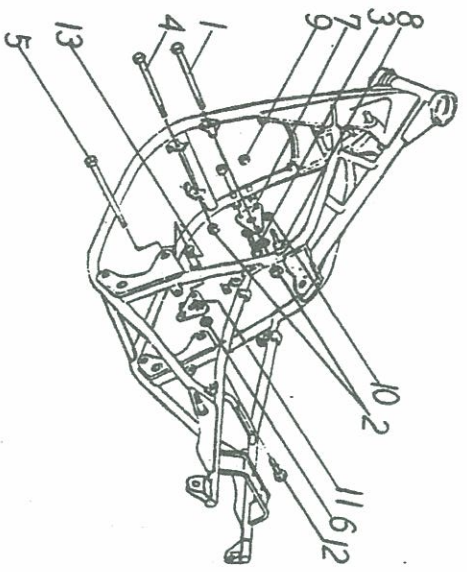

**3. Step**

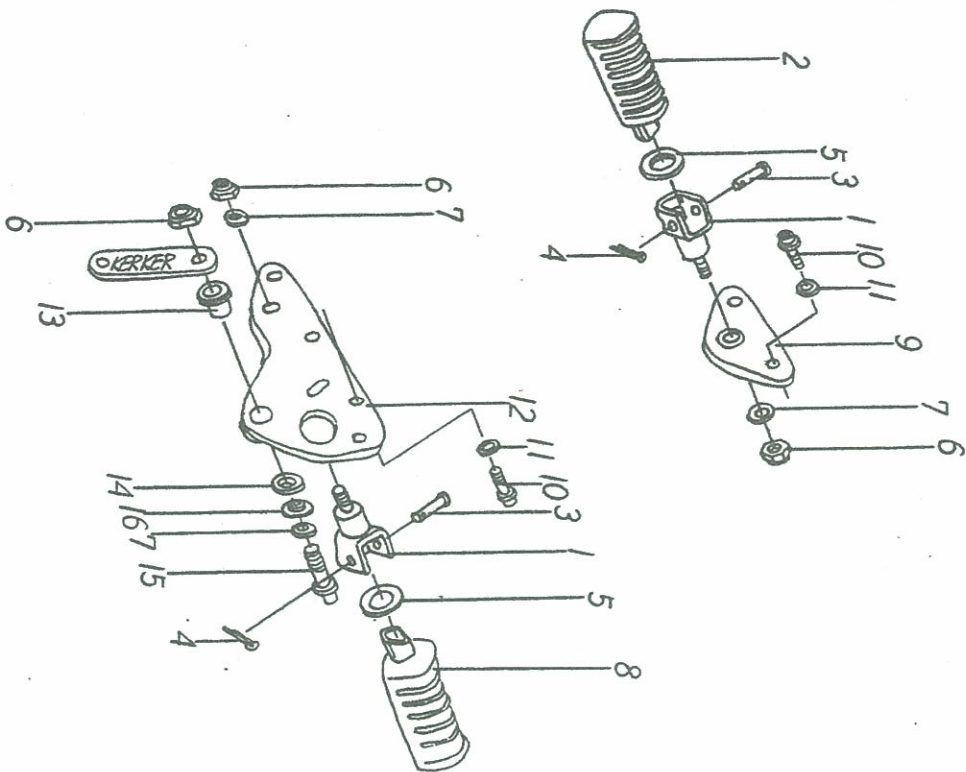

Ref. No.	Part No.	Description	Spec Code	Quantity - KZ1 000
*1	BGF141-020	HOLDER-STEP		2
2	34028-1024	STEP, LF		1
3	92043-079	PIN, 6 X 28		2
4	6S0D2012	PIN-COTTER, 2.0 X 12		2
5	92022-181	WASHER, 22.5 X 30 X 2.6		2
6	92019-004	NUT, LOCK, 10MM		3
7	410B1000	WASHER-PLANE-SMALL, 10MM		3
8	34028-1025	STEP, RH		1
*9	BGF142-010	BRACKET, STEP, LH		1
*10	Y120P0820	BOLT, 8 X 20		6
11	410B0800	WASHER-PLANE-SMALL, 8MM		5
*12	BGF142-300	BRACKET, STEP, RH		1
13	92092-1013	DAMPER		1
14	92076-1132	DAMPER		1
*15	Y120P1040	BOLT, 10 X 40		1
*16	BGF143-220	WASHER		1

4. Oil Cooler Fitting

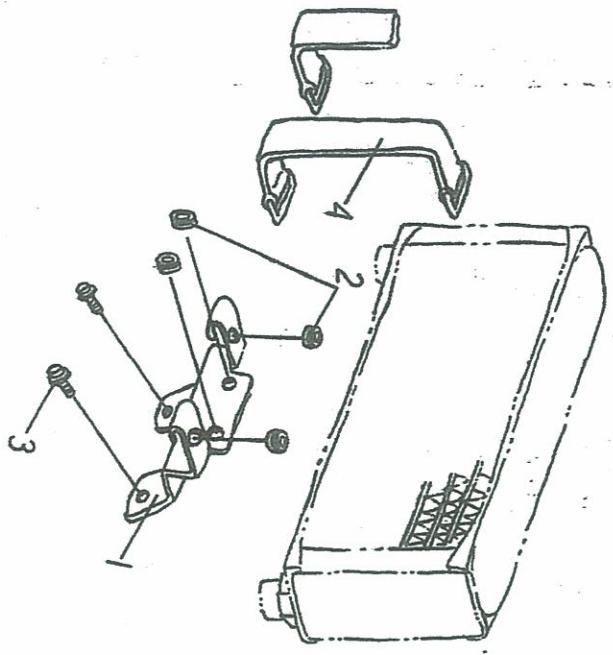

Ref. No.	Part No.	Description	Spec Code	Quantity	Unit
*1	BGF161-030	STAY, OIL COOLER		1	
2	9207B-076	DAMPER		4	
*3	Y120P0814	BOLT, 8 X 14		2	
*4	BGF161-034	BAND		2	

**5. Swing Arm, Oil Catch Tank**

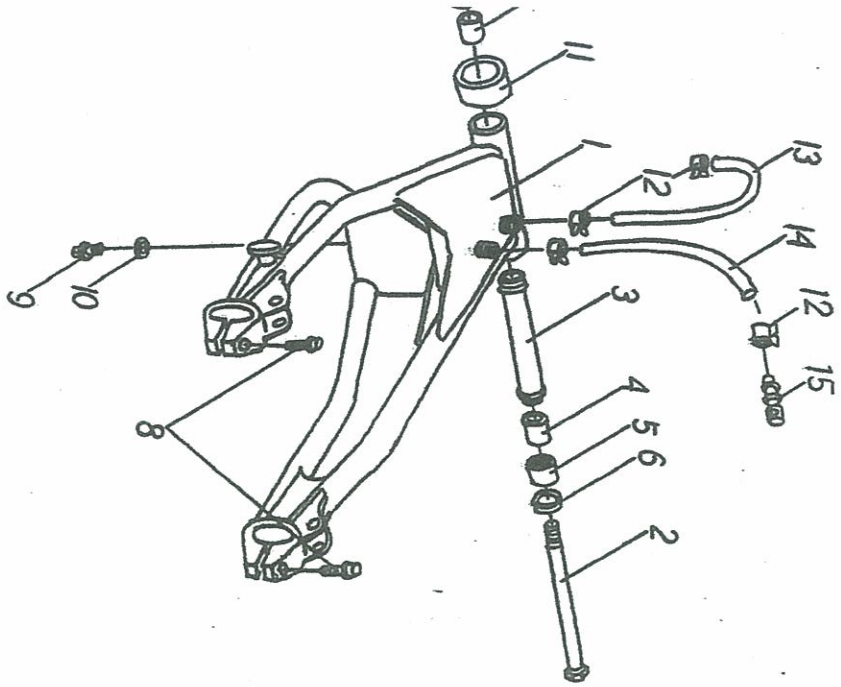

Ref. No.	Part No.	Description	Spec Code	Quantity - KZ1000
*1	BGF161-000	ARM-COMP-SWING		1
2	33032-036	SHAFT-SWING ARM		1
3	62027-1301	COLLAR, SWING ARM		1
4	42036-1041	SLEEVE, SWING ARM		2
5	62046-1035	BEARING-NEEDLE		2
6	62046-1060	SEAL-OIL		2
7	62019-012	NUT, LOCK, 16MM		1
*8	Y120P1235	BOLT, 12 X 35		2
*9	Y120P0812	BOLT, 8 X 12		1
10	410B0800	WASHER-PLANE-SMALL, 8MM		1
*11	BGF163-600	GUIDE-CHAIN		1
12	62037-1206	CLAMP		4
*13	BGF431-300	HOSE, SHORTER		1
*14	BGF431-310	HOSE, LONGER		1
*15	BGF431-360	CAP HOSE		1



### 6. Shock Absorber

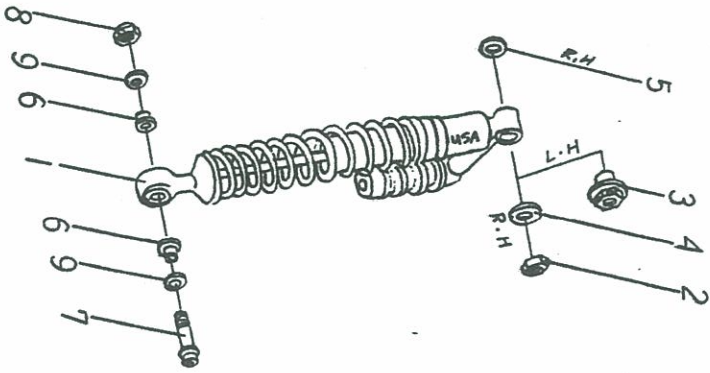

Ref. No.	Part No.	Description	Spec Code	Quantity - 1216
*1	BGC171-000	SHOCKABSORBER, RR		2
2	92016-1063	NUT, LOCK, 12MM		1
*3	BGF171-830	NUT		1
4	92022-1239	WASHER, 12.4 X 28 X 2.3		1
5	41181400	WASHER-PLANE, 14MM		1
*6	BGF171-860	COLLAR		4
*7	Y120P1045	BOLT, 10 X 45		2
8	92019-004	NUT, LOCK, 10MM		2
9	41081000	WASHER-PLANE-SMALL, 10MM		2





### 7. Fender

Ref. No.	Part No.	Description	Spec Code	Quantity - KZ1000			
				'92	'93	'94	'95
*1	BGF181-010	FENDER-FRONT		1			
2	114B0814	BOLT-SMALL, 8 X 14		4			
*3	BGF182-010	FENDER-REAR, RR		1			
4	63022-1071	FENDER-REAR, FR		1			
*5	BGF182-100	BRACKET		1			
*6	Y120P0614	BOLT, 6 X 14		4			
7	92019-008	NUT, LOCK, 6MM		4			
8	410B0600	WASHER-PLANE-SMALL, 6MM		4			
9	92022-241	WASHER, 5.2 X 16 X 1.6		2			
10	92022-323	WASHER, 6.2 X 16.5 X 1.2		2			

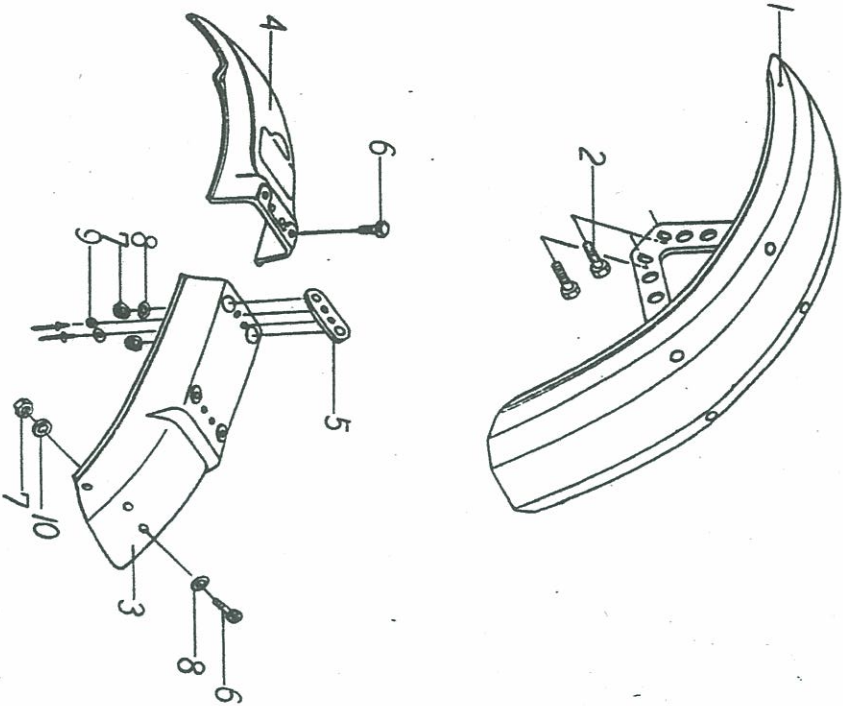



### 8. Front Hub

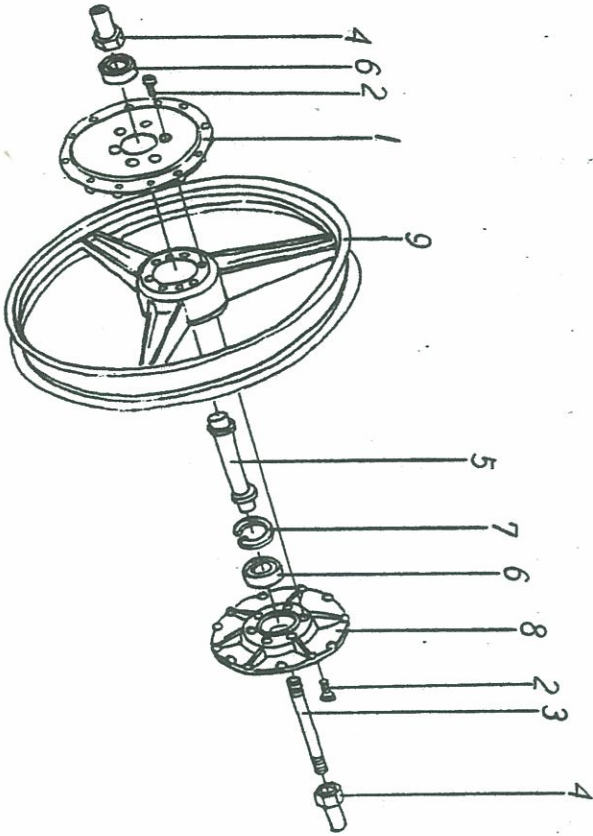

Ref. No.	Part No.	Description	Spec Code	Quantity - KIT
*1	BGF231-010	HOUSING-BEARING, LH		1
*2	808850-396	BOLT, 8MM TAPER		12
3	41088-048	AXLE, FR		1
*4	BGF231-080	NUT		2
*5	BGF231-100	COLLAR, BEARING		1
8	601A6304ZZ	BEARING-BALL		2
7	481J6200	CIRCLIP-TYPE C, 52MM		1
*8	BGF232-010	HOUSING-BEARING, RH		1
*9	AGC211-051	WHEEL, FR		1



### 9. Rear Hub

Ref. No.	Part No.	Description	Spec Code	Quantity - KZ1000			
				82	81		
*1	AGC241-010	HOUSING-SPROCKET		1			
*2	AGC241-020	STUD		6			
*3	AGC241-080	AXLE, RR		1			
*4	BGC241-070	WASHER		1			
*5	AGC241-100	COLLAR, BEARING		1			
*6	BGC241-110	COLLAR, INNER, LH		1			
*7	798850-410	BEARING, NJ2205		1			
*8	BGF241-310	COUPLING		1			
*9	BGF241-320	HOUSING		1			
10	120P0512	BOLT-SOCKET, 5 X 12		12			
*11	AGC241-510	BOLT, 10MM TAPER		10			
*12	BGF241-380	DAMPER		6			
13	67182580	O RING, 80MM		1			
14	671825135	O RING, 135MM		1			
*15	BGF241-470	BOSS, LH		1			
*16	BGF242-010	HOUSING-BEARING, RH		1			
*17	AGC242-110	COLLAR, INNER, RH		1			
*18	AGC242-120	COLLAR, OUTER, RH		1			
*19	AGC242-130	COLLAR		1			
20	670C3036	O RING, 36MM		2			
21	601A6205ZZ	BEARING-BALL		1			
22	481J5200	CIRCLIP-TYPE C, 52MM		1			
*23	BGF242-470	BOSS, RH		1			
*24	BGF243-330	SPROCKET, 33T, OPTION		1			
*24	BGF 243-340	SPROCKET, 34T, OPTION		1			
*24	BGF243-350	SPROCKET, 35T, STD		1			
*24	BGF243-360	SPROCKET, 36T, OPTION		1			
*24	BGF243-370	SPROCKET, 37T, OPTION		1			
*25	AGC213-111	WHEEL, RR		1			

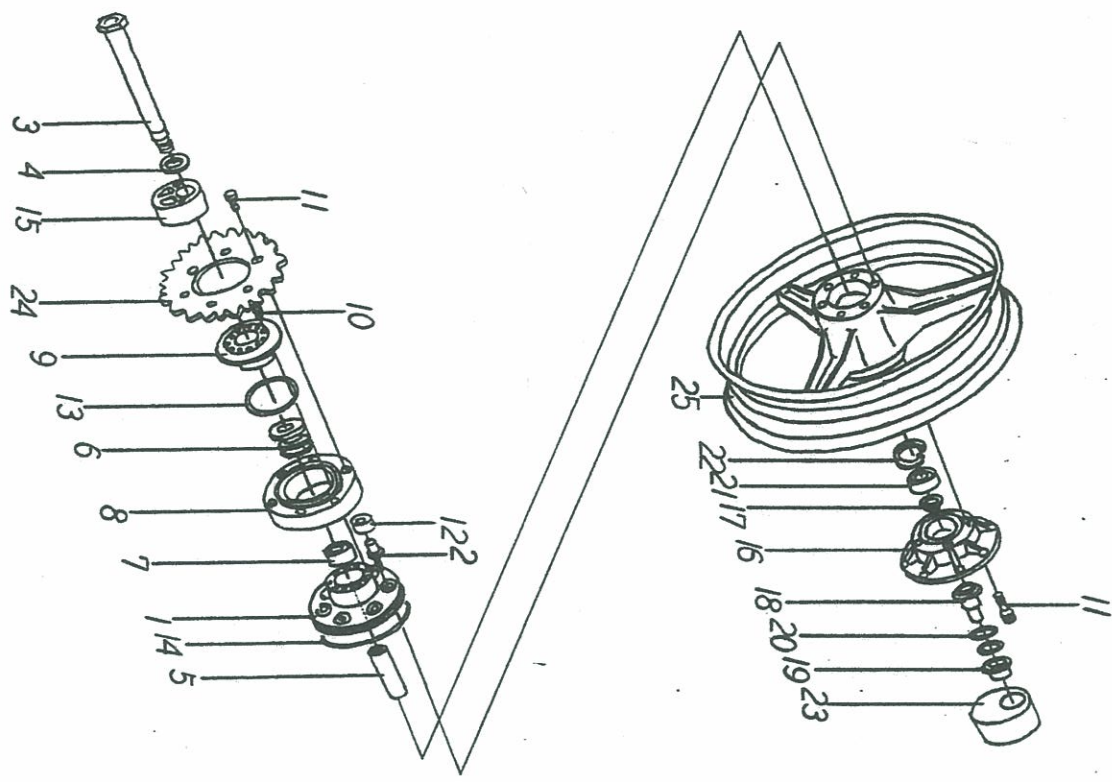



### 10. Drive Chain

Ref. No.	Part No.	Description	Spec Code	Quantity - KIT	
				'92	'91
*1	8GFE261-010	CHAIN, DRIVE		1	
*2	8GGE261-020	JOINT-CHAIN, DRIVE		1	

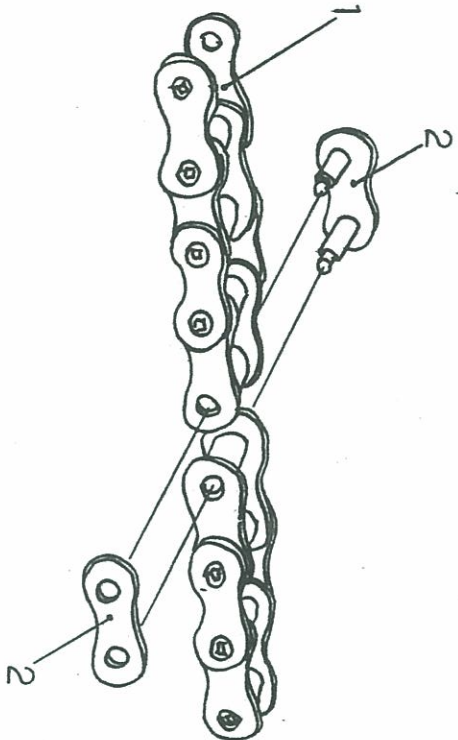

**11. Front Brake**

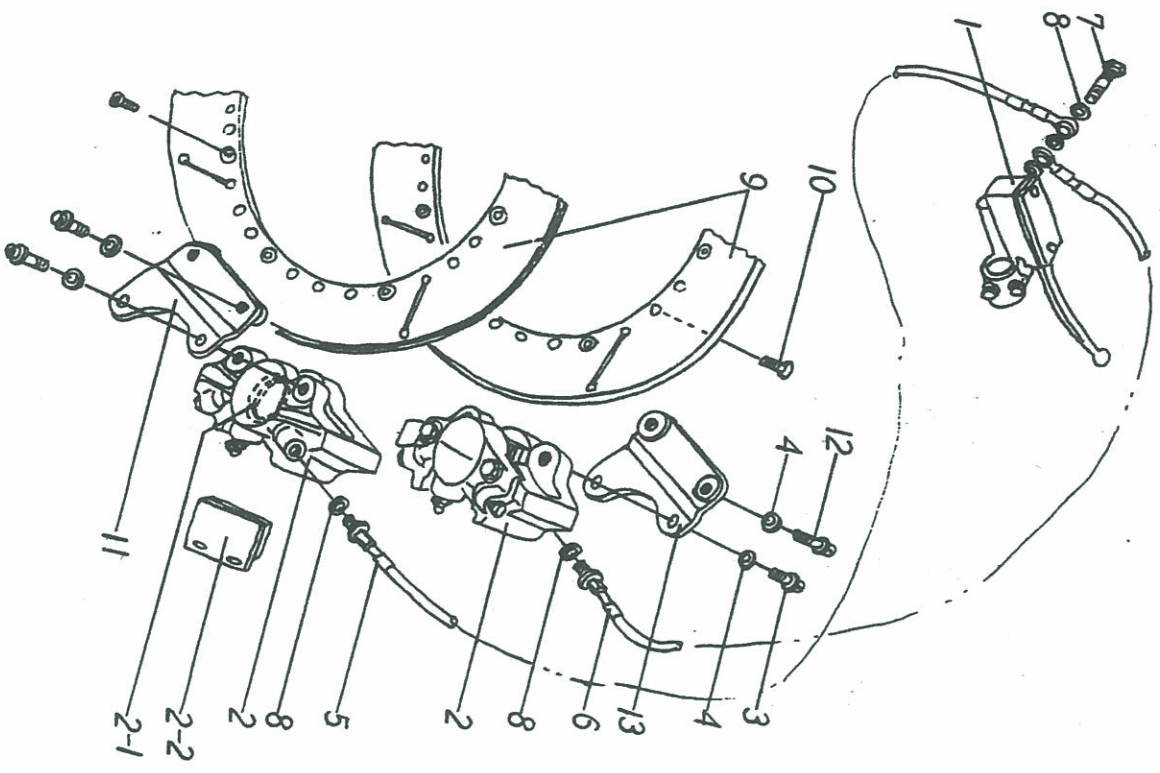

Ref. No.	Part No.	Description	Spec Code	Quantity - KZ1000
*1	BGF261-000	CYLINDER-ASSY-MASTER, FR		1
*2	789820-509	CALIPER-ASSY, FR		2
*2-1	789820-486	RING, TYPE-SQUARE		4
*2-2	789820-515	PAD-BRAKE, A314		4
*3	Y120P1022	BOLT, 10 X 22		4
4	410B1000	WASHER-PLANE-SMALL, 10MM		8
*5	BGF264-100	HOSE-BRAKE, FR, LH, L = 891		1
*6	BGF264-110	HOSE-BRAKE, FR, RH, L = 891		1
*7	BGF264-200	BOLT, BANJO		1
8	43067-001	WASHER, OIL		3
*9	BGF266-010	DISK, FR		2
*10	Y219P0614	BOLT, 6 X 14		24
*11	BGF266-010	BRACKET, CALIPER, LH		1
*12	Y120P1035	BOLT, 10 X 35		4
*13	BGF267-010	BRACKET, CALIPER, RH		1

**12. Rear Brake**

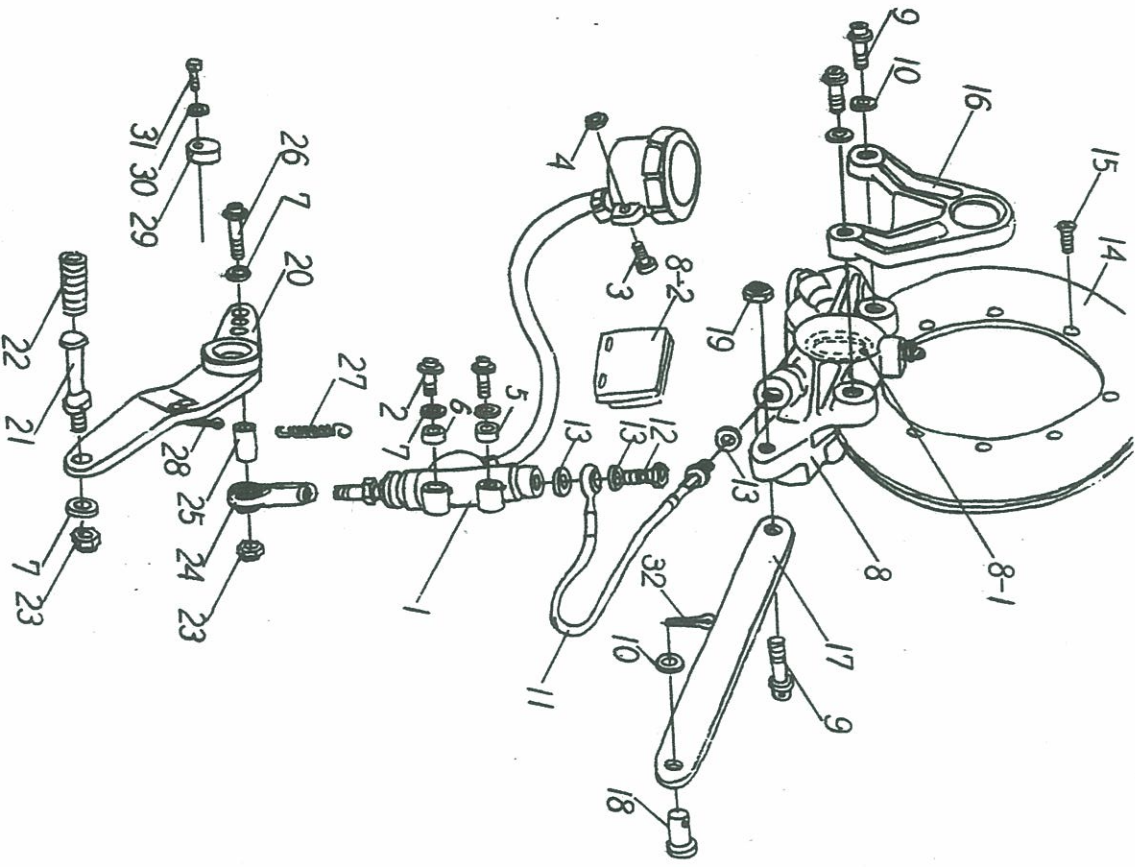

Ref. No.	Part No.	Description	Spec Code	Quantity	Unit
				92	
				51	

1	43016-1076	CYLINDER-ASSY-MASTER, RR		1	
*2	Y120P0828	BOLT, 8 X 28		2	
*3	Y120P0820	BOLT, 6 X 20		1	
4	92019-008	NUT, LOCK, 6MM		1	
*5	BGF271-370	COLLAR, 8.5 X 16 X 8		1	
*6	BGF271-380	COLLAR, STAIR TYPE		1	
7	410B0800	WASHER-PLANE-SMALL, 8MM		4	
*8	789921-680	CALLIPER-ASSY, RR		1	
*8-1	809860-684	RING, TYPE-SQUARE		2	
*8-2	789820-696	PAD-BRAKE, S31		2	
*9	Y120P1028	BOLT, 10 X 28		3	
10	410B1000	WASHER-PLANE-SMALL, 10MM		3	
*11	BGF274-100	HOSE-BRAKE, RR, L = 711		1	
*12	BGF284-210	BOLT, BANJO		1	
13	43067-001	WASHER, OIL		3	
*14	BGE276-010	DISK, RR		1	
*15	Y219P0614	BOLT, 6 X 14		8	
*16	BGF276-010	BRACKET, CALIPER		1	
*17	BGF276-300	ROD-TORQUE		1	
*18	BGF276-460	PIN		1	
19	92019-004	NUT, LOCK, 10MM		1	
*20	BGF277-010	LEVER-BRAKE		1	
*21	BGF277-020	PEDAL, BRAKE		1	
22	13157-004	DAMPER, PEDAL		1	
23	92016-1124	NUT, LOCK, 8MM		2	
*24	Y609C0800	PILLOW BALL, R8T8		1	
*26	BGF277-340	COLLAR		1	
*28	Y120P0846	BOLT, 8 X 46		1	
27	92081-1296	SPRING, BRAKE PEDAL		1	
28	650D3250	PIN-COTTER, 3.2 X 50		1	
*29	BGF277-600	STOPPER		1	
30	410B0600	WASHER-PLANE-SMALL, 6MM		1	
*31	Y120P0614	BOLT, 6 X 14		1	
32	650D2020	PIN-COTTER, 25 X 20		1	
12					

**13. Handlebar**

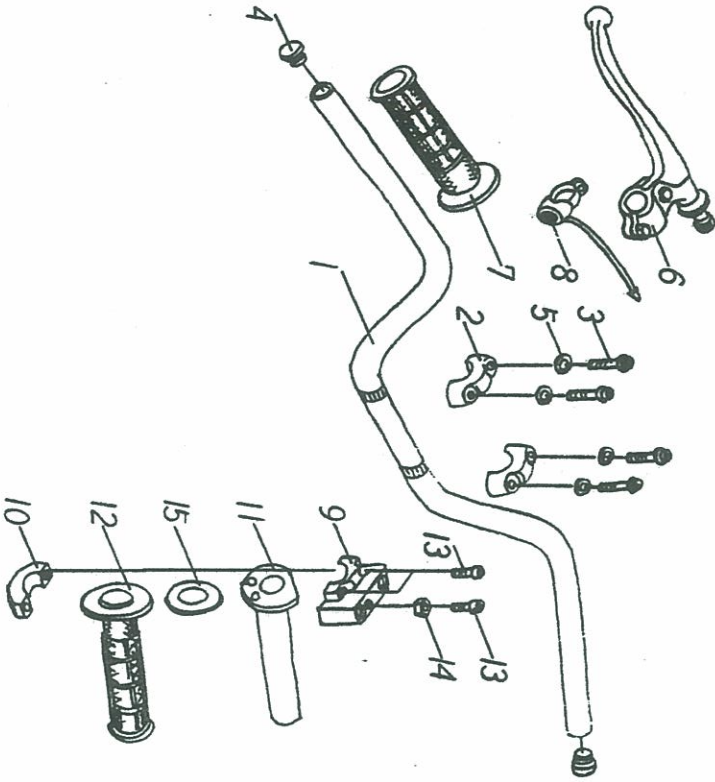

Ref. No.	Part No.	Description	Spec Code	Quantity - KZ1000
1	46003-1078	HANDLE		1
2	46012-1011	HOLDER-HANDLE		2
*3	Y120P0835	BOLT, 8 X 35		4
*4	BGF311-250	PLUG, HANDLE		2
5	41080800	WASHER-PLANE-SMALL, 8MM		4
6	46076-048	LEVER-ASSY, CLUTCH		1
*7	BGC321-200	GRIP, LH		1
8	46027-013	SWITCH, STOP		1
*9	798880-632	HOUSING-CONTROL, RH, UPP		1
*10	798880-633	HOUSING-CONTROL, RH, LWR		1
*11	639001-086	HOLDER-HOUSING CONTROL		1
*12	BGC325-240	GRIP, RH		1
*13	Y120P0620	BOLT, 6 X 20		3
14	312G0600	NUT, 6MM		1
*15	BGE325-300	WASHER		1

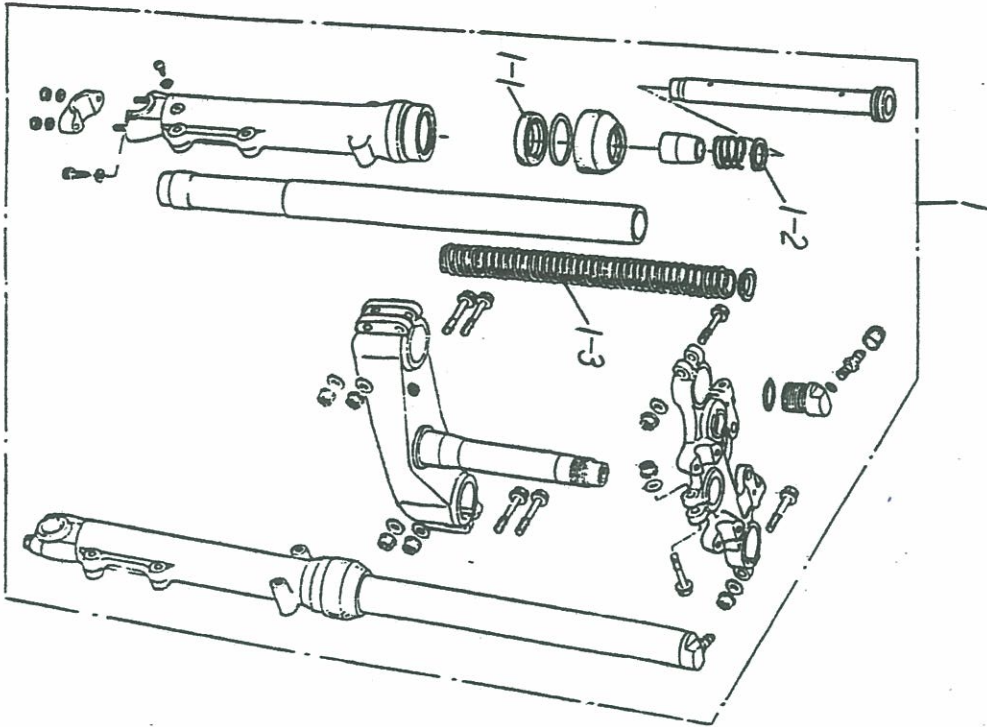

### 14. Front Fork

Ref. No.	Part No.	Description	Spec Code	Quantity
*1	BGF340-000	FORK-FRONT		1
1-1	92048-1066	SEAL-OIL, FORK		2
*1-2	BGF341-740	RING-SEAL, FORK		2
*1-3	BGF341-840	SPRING-FRONT FORK, K-0.6, OPTION		2
*1-3	BGF341-960	SPRING-FRONT FORK, K-0.7, STD		2
*1-3	BGF341-980	SPRING-FRONT FORK, K-0.8, OPTION		2





### 15. Steering

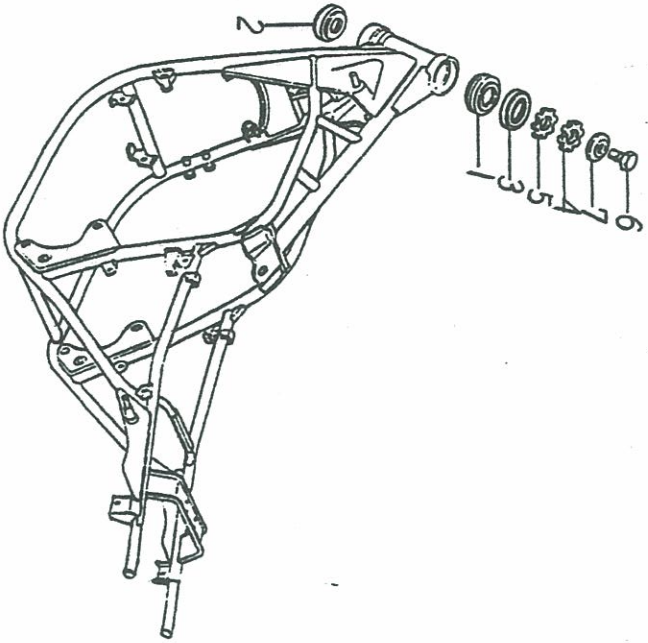

Ref. No.	Part No.	Description	Spec Code	Quantity - KZ1000			
				152	151		
1	82047-017	RACE ROLLER		1			
2	92116-1009	BEARING-ROLLER		1			
3	46098-017	CAP, STEERING STEM		1			
4	92015-1128	NUT, 25MM, T = 8		1			
5	92015-1128	NUT, 25MM, T = 10		1			
6	113G1425	BOLT-SMALL-FINE, 14 X 25		1			
7	92022-1229	WASHER, 14.5 X 38 X 4.5		1			



### 16. Shock Absorber Steering

Ref. No.	Part No.	Description	Spec Code
*1	BGF362-011	SHOCKABSORBER, STEERING	1
*2	Y609H0800	PILLOW BALL	1
*3	Y120F0828	BOLT, 8 X 28	2
4	410B0800	WASHER-PLANE-SMALL, 8MM	6
*5	Y609F0800	PILLOW BALL	1
6	318G0800	NUT-HEX-SMALL, 8MM	1
7	92016-1124	NUT, LOCK, 8MM	1

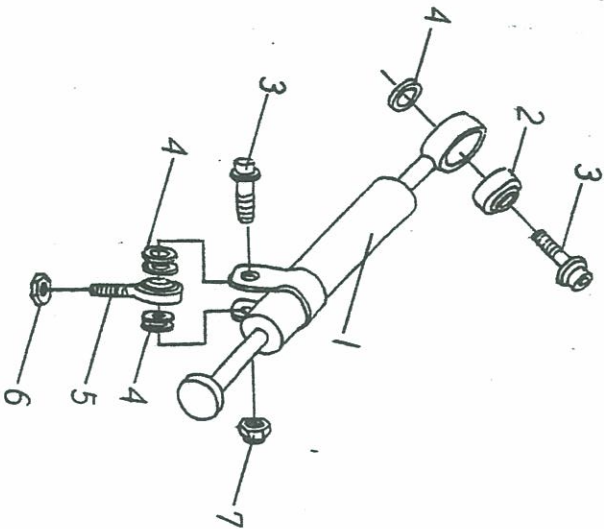

**17. Fuel Tank**

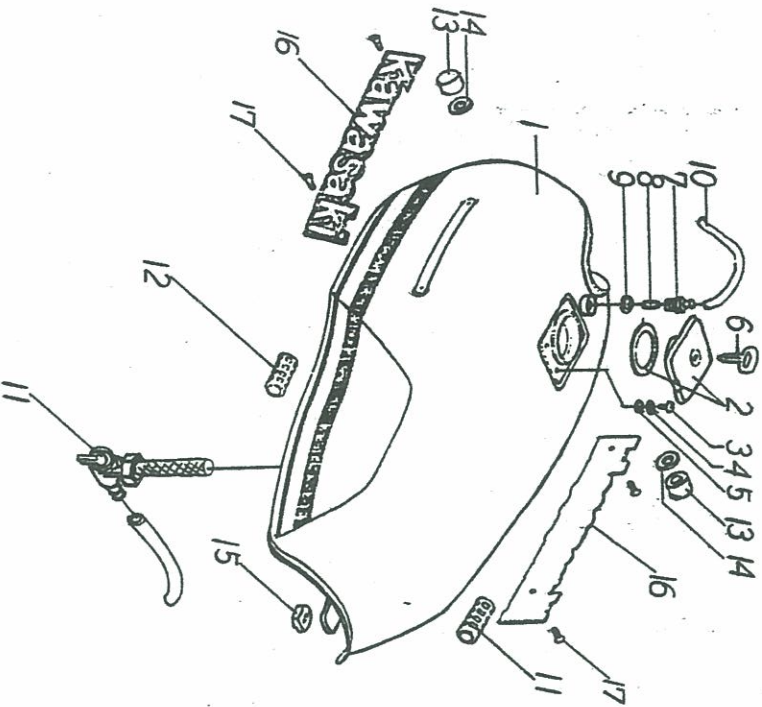

Ref. No.	Part No.	Description	Spec Code	Quantity - KZ1000				
				'92	'93	'94	'95	'96
*1	BGF411-000	TANK-COMP-FUEL		1				
2	51048-1018	CAP-ASSY-TANK		1				
3	220B0810A	SCREW-PAN-CROS, 5 X 10		2				
4	92022-1038	WASHER, 5.3 X 10 X 0.8		2				
5	92056-1023	RING-O		2				
6	27008-1015	KEY-LOCK, BLANK		1				
*7	AGC421-200	CASE-BREATHER		1				
*8	BGE421-210	FLOAT		1				
9	67082012	O RING, 12MM		1				
10	701007800	TUBE-PVC, 7 X 11 X 800		1				
*11	BGC422-010	TAP-ASSY, FUEL		1				
12	92075-084	DAMPER, FUEL TANK		2				
13	92075-125	DAMPER, FUEL TANK		2				
14	92022-044	WASHER, 10.5 X 28 X 2.3		2				
15	92075-285	DAMPER, FUEL TANK		1				
16	56014-1043	EMBLEM, FUEL TANK		2				
17	92008-003	SCREW-COUNTERSUNK, 3 X 6		4				

**18. Seat**

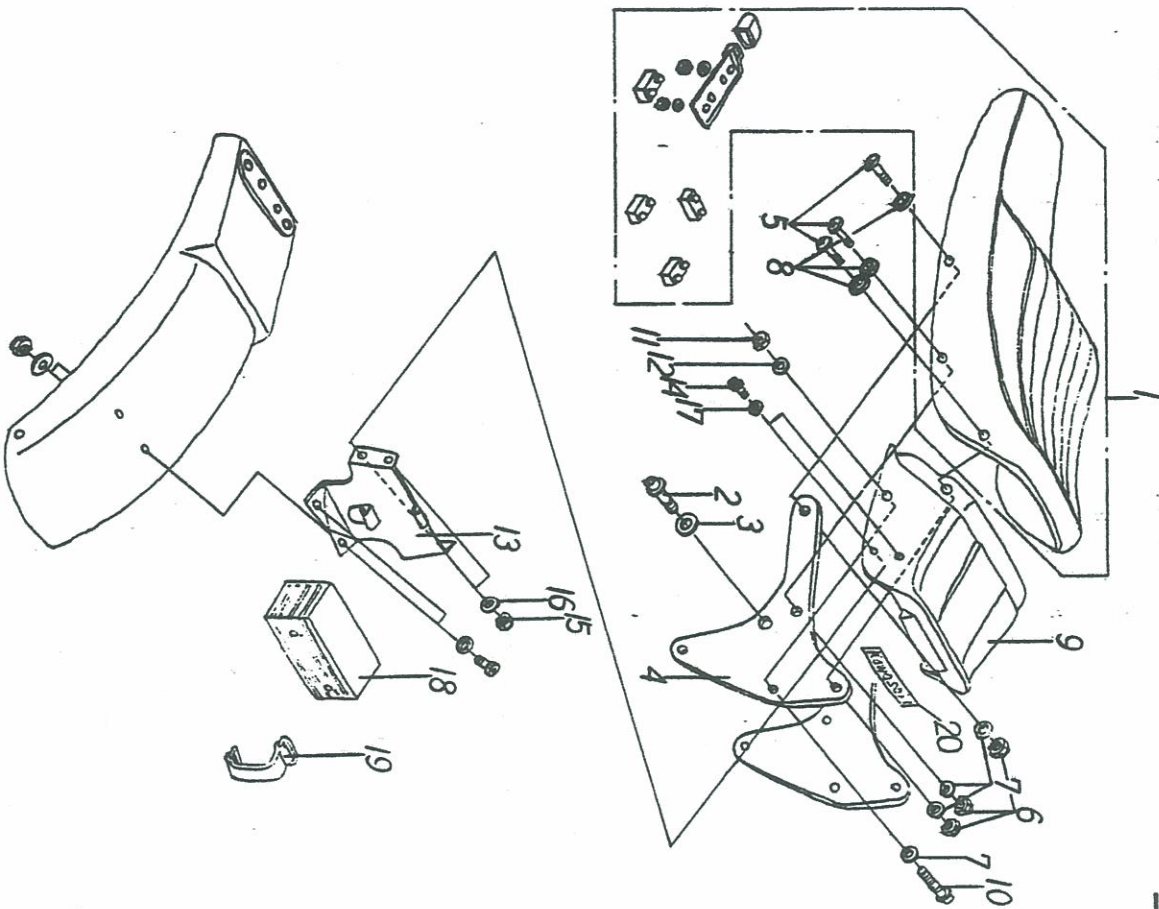

Ref. No.	Part No.	Description	Spec Code
*1	BGF611-010	SEAT-ASSY	
*2	Y120P1016	BOLT, 10 X 18	
3	410B1000	WASHER-PLANE-SMALL, 10MM	
*4	BGF611-300	BRACKET-SEAT	
	221B0830	SCREW-CSK-CROS, 8 X 30	
6	92015-1124	NUT, LOCK, 8MM	
7	410B0800	WASHER-PLANE-SMALL, 8MM	
*8	BGF611-370	WASHER COVER, SEAT	
*9	BGF612-010	COVER, SEAT	
*10	Y120P0828	BOLT, 8 X 28	
11	318G0800	NUT-HEX-SMALL	
12	92022-1317	WASHER COVER, BRACKET	
*13	BGF612-230	BOLT, 6 X 14	
*14	Y120P0614	NUT, LOCK, 16MM	
15	92019-008		
18	410B0800	WASHER-PLANE-SMALL, 8MM	
17	92022-323	WASHER, 6.2 X 18.5 X 1.2	
18	23026-1021	LENS, TAIL LAMP	
19	92072-045	BAND	
20	56018-1208	MARK, SEAT COVER	

Quantity	Unit	Code
01		

**19. Meter**

Ref. No.	Part No.	Description	Spec Code	Quantity - KZ1000			
				92	93	94	95
*1	BGE611-011	TACHOMETER					
*2	BGF611-040	BRACKET, TACHOMETER					
*3	Y120P0612	BOLT, 6 X 12					
4	92019-008	NUT, LOCK, 6MM					
5	410B0600	WASHER-PLANE-SMALL, 6MM					
6	26005-1106	SPEEDOMETER					
7	92075-1315	DAMPER, METER					
8	92075-1316	DAMPER					
9	14025-1344	COVER, SPEEDOMETER					
10	92001-1442	BOLT, 6 X 8					
11	92022-1248	WASHER, 6.2 X 26 X 1					
12	92003-204	BOLT, 6 X 14					
13	26008-1034	BRACKET-METER					
*14	Y120P0814	BOLT, 8 X 14					
15	410B0800	WASHER-PLANE-SMALL, 8MM					

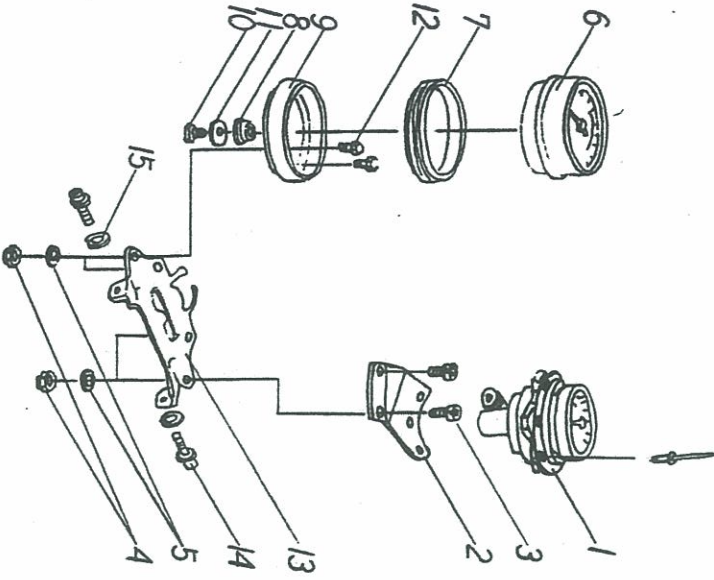



## 20. Cable

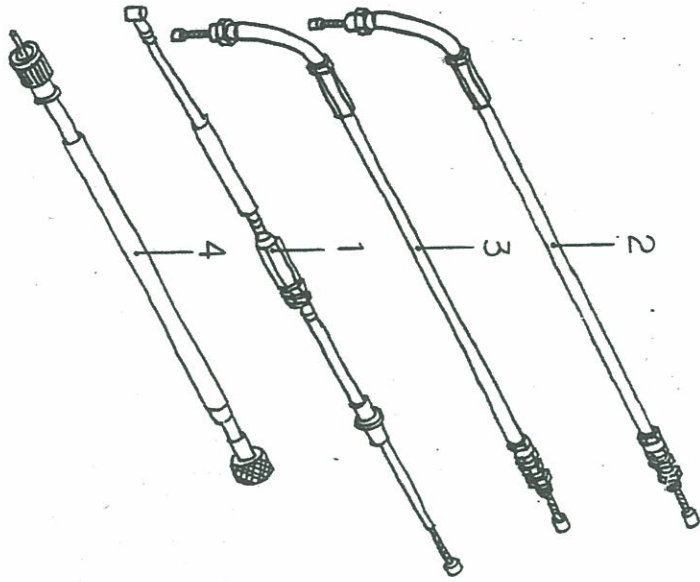

Ref. No.	Part No.	Description	Spec Code	Quantity
1	54011-1018	CABLE-CLUTCH		1
2	54012-1030	CABLE-THROTTLE		1
3	54012-1031	CABLE-THROTTLE		1
4	54018-1003	CABLE-TACHOMETER		1

**21. Fairing**

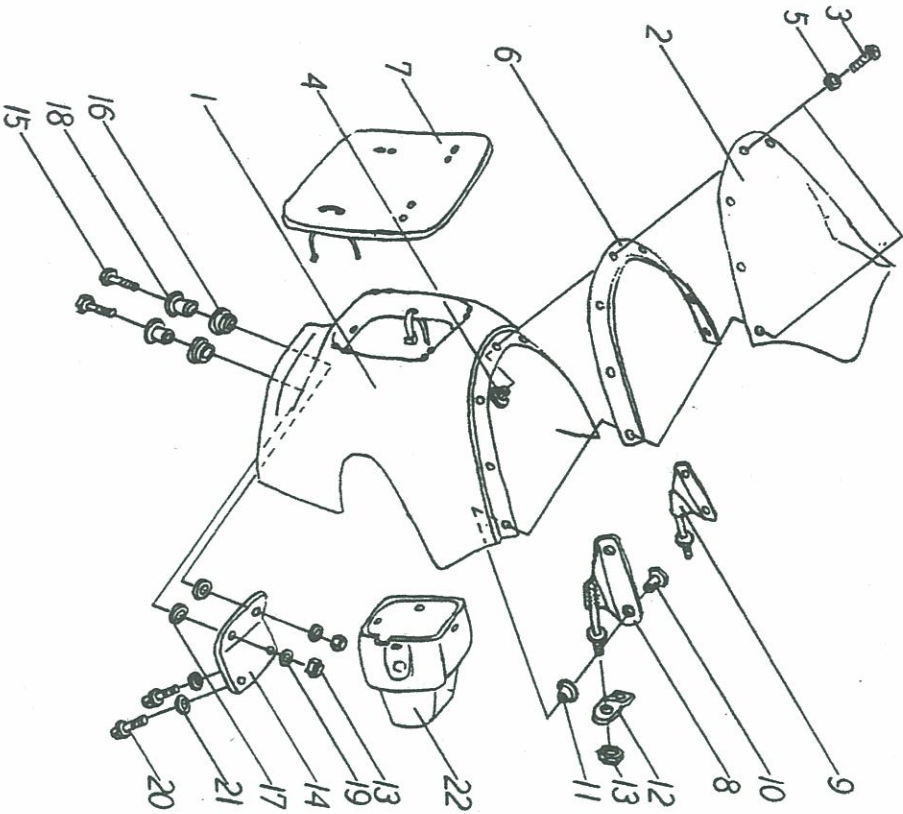

Ref. No.	Part No.	Description	Spec Code	Quantity - KZ1000			
				'82	'81		

*1	BGF811-020	FAIRING		1			
2	38164-1008	WINDSHIELD		1			
3	92009-1020	SCREW		7			
4	92016-1025	NUT, 6MM		3			
5	92022-1038	WASHER, 6.3 X 10 X 0.8		7			
6	53044-1036	TRIM, FAIRING		1			
*7	BGF811-500	NUMBER PLATE		1			
8	11036-1349	BRACKET, FAIRING, LH		1			
9	11036-1350	BRACKET, FAIRING, RH		1			
10	92016-1150	NUT, 5MM		4			
11	92076-1138	DAMPER, 8MM		4			
12	11036-1439	BRACKET, FAIRING		2			
13	92019-008	NUT, LOCK, 6MM		4			
*14	BGF812-310	BRACKET, FAIRING, LWR		1			
*15	Y120P0620	BOLT, 6 X 20		2			
16	92076-174	DAMPER		2			
17	92076-175	DAMPER		2			
18	92027-1450	COLLAR, L = 13.1		2			
19	410B0600	WASHER-PLANE-SMALL, 6MM		2			
*20	Y120P0810	BOLT, 8 X 10		2			
21	410B0800	WASHER-PLANE-SMALL, 8MM		2			
*22	BGF831-020	BODY-COMP-HEAD		1			

**22. Number Plate**

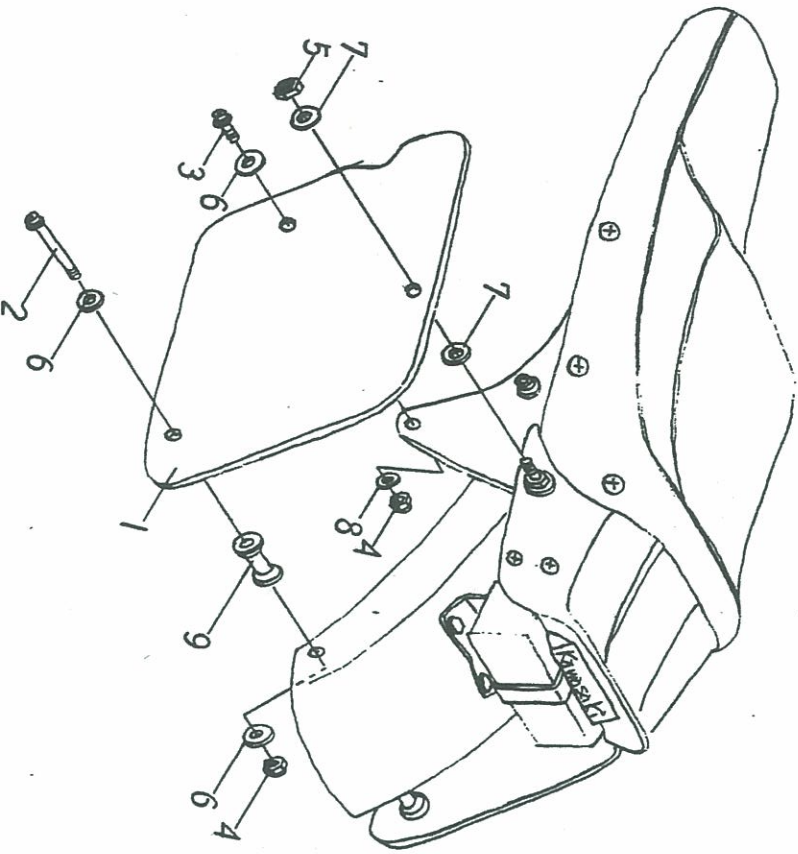

Ref. No.	Part No.	Description	Spec Code	Quantity	
				81	82
*1	BGF813-010	NUMBER PLATE, SIDE		2	
*2	Y120P0675	BOLT, 6 X 75		2	
*3	Y120P0616	BOLT, 6 X 16		2	
4	92018-008	NUT, LOCK, 6MM		4	
5	92016-1124	NUT, LOCK, 8MM		2	
6	92022-323	WASHER, 6.2 X 18.5 X 1.2		6	
7	92022-1317	WASHER, 8.5 X 20 X 1.6		4	
8	410B0600	WASHER-PLANE-SMALL, 6MM		2	
*9	BGF813-130	COLLAR		2	



**23. Side Cover**

Ref. No.	Part No.	Description	Spec Code	Quantity - KZ1000				
				92				
*1	36001-1109	COVER-SIDE, LH		1				
*2	36001-1108	COVER-SIDE, RH		1				
3	92071-058	GROMMET		5				

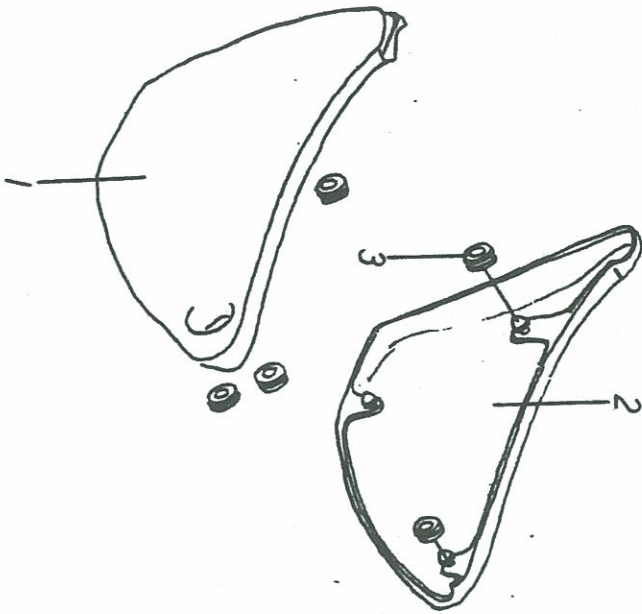

**24. Gear Change Mechanism**

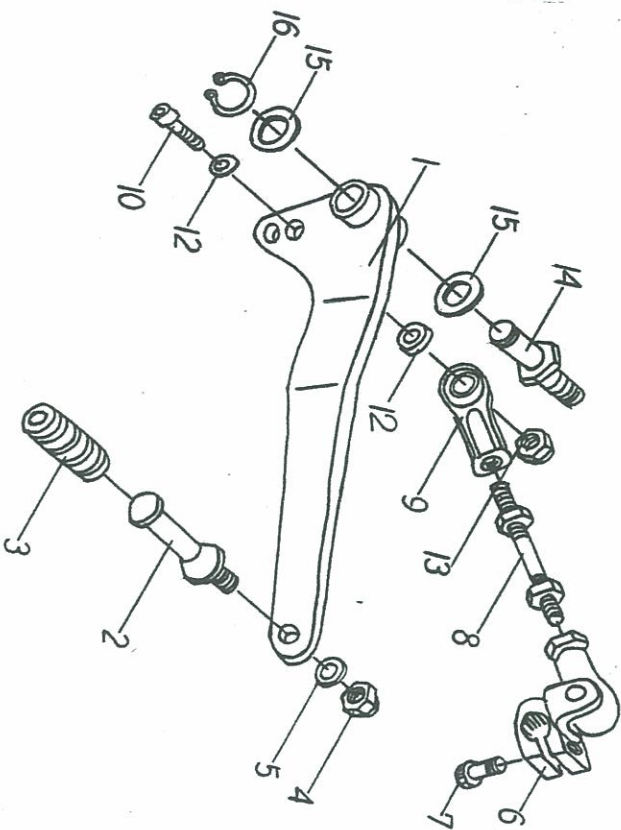

Ref. No.	Part No.	Description
*1	BGF821-010	LEVER-CHANGE, PEDAL
*2	BGF277-020	PEDAL, CHANGE
3	13157-004	DAMPER, CHANGE PEDAL
4	92015-1124	NUT, LOCK, 8MM
5	41080800	WASHER-PLANE-SMALL, 8MM
6	13242-1048	ROD END, CHANGE LEVER
*7	Y120P0620	BOLT, 6 X 20
8	39110-1002	ROD-ASSY-TIE
*9	Y608C0600	PILLOW BALL
10	120P0622	BOLT-SOCKET, 6 X 22
12	41080600	WASHER-PLANE-SMALL, 8MM
13	92019-008	NUT, LOCK, 8MM
14	92004-1034	STUD, CHANGE PEDAL PIVOT
15	92022-072	WASHER, 12.5 X 21 X 1.2
16	480U1200	CIRCLIP-TYPE-C, 12MM

Ref. No.	Part No.	Description	Spec Code	Quantity	Unit
*1	BGF821-010	LEVER-CHANGE, PEDAL		92	
*2	BGF277-020	PEDAL, CHANGE		91	
3	13157-004	DAMPER, CHANGE PEDAL			
4	92015-1124	NUT, LOCK, 8MM			
5	41080800	WASHER-PLANE-SMALL, 8MM			
6	13242-1048	ROD END, CHANGE LEVER			
*7	Y120P0620	BOLT, 6 X 20			
8	39110-1002	ROD-ASSY-TIE			
*9	Y608C0600	PILLOW BALL			
10	120P0622	BOLT-SOCKET, 6 X 22			
12	41080600	WASHER-PLANE-SMALL, 8MM			
13	92019-008	NUT, LOCK, 8MM			
14	92004-1034	STUD, CHANGE PEDAL PIVOT			
15	92022-072	WASHER, 12.5 X 21 X 1.2			
16	480U1200	CIRCLIP-TYPE-C, 12MM			

# Numerical Parts Index

Part No.	Page	Part No.	Page	Part No.	Page	Part No.	Page
92015-1124	16	92075-1138	21				
92015-1124	24	92075-125	17				
92015-1124	12	92075-1315	19				
92015-1124	22	92075-1316	19				
92015-1129	15	92075-174	21				
92015-1150	15	92075-175	21				
92019-004	12	92075-295	17				
92019-004	3	92081-1296	12				
92019-004	6	92091-022	2				
92019-004	2	92092-1013	3				
92019-008	24	92116-1009	15				
92019-008	25						
92019-008	22						
92019-008	21						
92019-008	19						
92019-008	18						
92019-008	12						
92019-012	7						
92022-044	5						
92022-072	17						
92022-1038	24						
92022-1038	17						
92022-1229	21						
92022-1239	15						
92022-1248	6						
92022-1317	19						
92022-1317	22						
92022-181	18						
92022-241	3						
92022-323	7						
92022-323	22						
92022-323	22						
92022-323	25						
92022-323	18						
92022-323	7						
92027-1301	5						
92027-1450	21						
92037-1206	5						
92043-079	3						
92046-1035	5						
92047-017	15						
92049-1060	5						
92049-1066	14						
92055-1023	17						
92071-056	25						
92072-045	18						
92075-076	4						
92075-084	17						
92075-1132	3						