



**KZ1000-S1 Engine  
&  
KZ1000J Kit**

**Parts Catalog**

© Kawasaki Heavy Industries, Ltd. 1982

Jan. 12, 1982

INDEX		* APPLICATION			
FIG NO.	MAIN TITLE	PAGE	KZ1000-S1	KZ1000J	
			ENGINE	FULL KIT	A KIT
1.	CYLINDER HEAD .....	1	●	●	
2.	CYLINDER HEAD COVER .....	2	●	●	
3.	CYLINDER.....	3	●	●	
4.	PISTON.....	4	●	●	
5.	VALVE .....	5	●	●	
6.	CAMSHAFT, TENSIONER .....	6	●	●	
7.	CRANKSHAFT .....	7	●	●	
8.	CLUTCH .....	8	●	●	
9.	TRANSMISSION .....	9	●	●	●
10.	CHANGE DRUM, SHIFT FORK .....	12	●	●	●
11.	GEAR CHANGE MECHANISM .....	13	●		
12.	CRANKCASE .....	14	●	●	
13.	CRANKCASE BOLT PATTERN .....	15	●	●	
14.	ENGINE COVER .....	16	●	●	
15.	ENGINE COVER "A" .....	17	●	●	
16.	OIL PUMP .....	18	●		
17.	GENERATOR .....	19	●	●	
18.	IGNITION COIL .....	20	●	●	
19.	OIL COOLER .....	21	●	●	
20.	TOOL .....	22	●	●	

Remarks : \*

PARTS NUMBER	DESCRIPTION
71000-1098-LF	ENGINE ASSY - KZ1000-S1
99996-1032	FULL KIT - KZ1000J
99996-1033	A KIT - KZ1000J





E1112-00-00

## 2. Cylinder Head Cover

Ref. No.	Part No.	Description	Spec Code	Quantity - KZ1000	
				82	S1

11009	11009-1205	GASKET, CYLINDER HEAD COVER		1	
11009A	92065-103	GASKET, TACHOMETER GEAR		1	
13091	13091-1008	HOLDER, TACHOMETER, T=2.3		1	
13091A	13091-1009	HOLDER, TACHOMETER, T=3.2		1	
14025	14025-1464	COVER, CYLINDER HEAD, BLACK		1	
41060	13223-011	GEAR-METER SCREW, 10T		1	
92001	92001-1350	BOLT, FLANGED, 6X45		20	
92001A	92001-1353	BOLT, FLANGED, 6X52		4	
92049	92050-075	SEAL-OIL, TACHOMETER		1	
92087	92087-010	BUSHING-METER GEAR, TACHOMETER		1	
120	120P0614	BOLT-SOCKET, 6X14		1	
670	670D1510	O RING, 10MM		1	

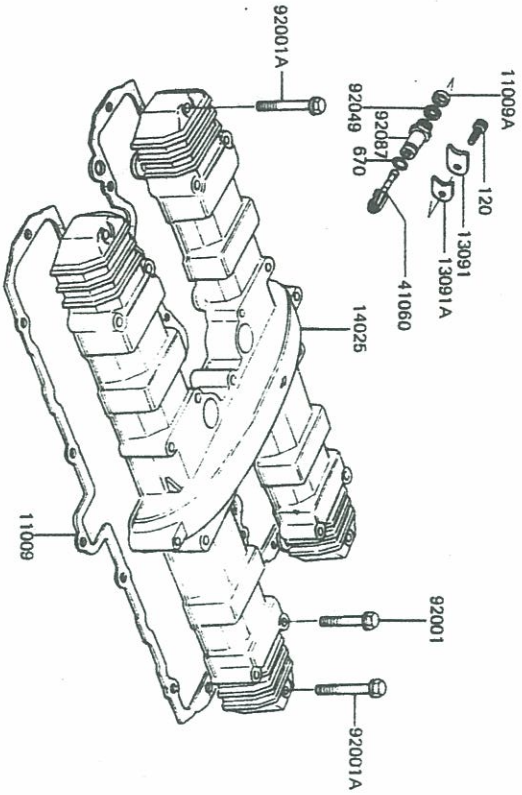





E1120-0029

### 3. Cylinder

Ref. No.	Part No.	Description	Spec Code	Quantity-KZ1000
				92
				51

11005	11005-1118	CYLINDER-ENGINE/BLACK		1
11009	11009-1207	GASKET,CYLINDER BASE		1
11009A	11009-1208	GASKET,CYLINDER		1
92043	92042-028	PIN,DOVEL,11X14X12.5		2
92043A	92043-1037	PIN,DOVEL,10X14		2
92055	92055-1096	RING-0,1D=13.4		4

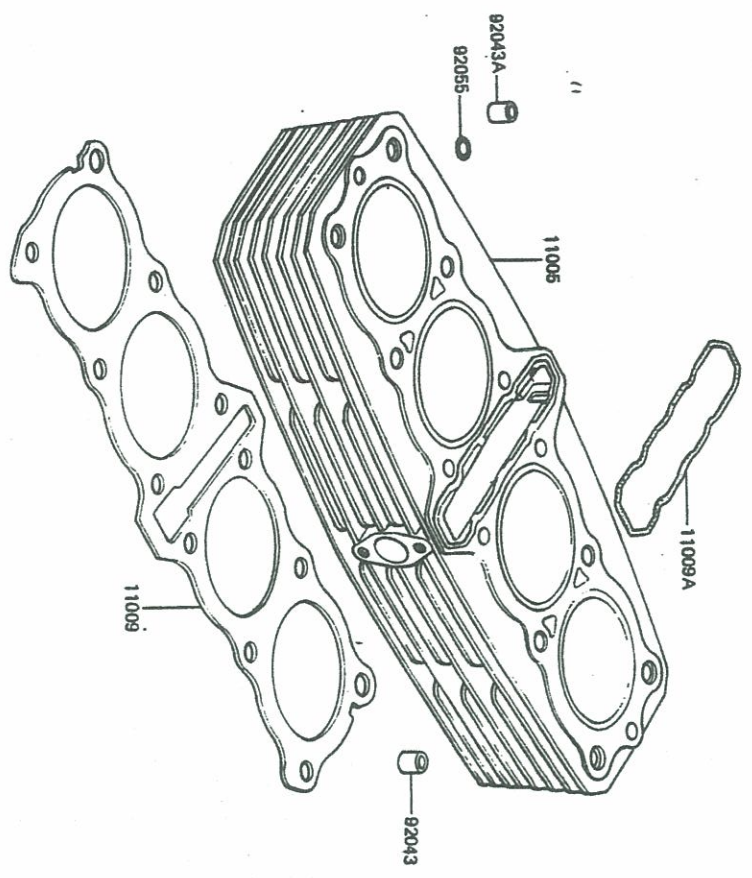



E1120A-00301

### 4. Piston

Ref. No.	Part No.	Description	Spec Code	Quantity-	
				g2	S1
13001	13001-1087	PISTON-ENGINE,STD		4	
	(RACING USE ONLY)				
13002	13002-1013	PIN-PISTON		4	
13008	13008-5048	RING-SET-PISTON,STD		4	
	(RACING USE ONLY)				
92033	92033-1054	RING-SNAP		8	

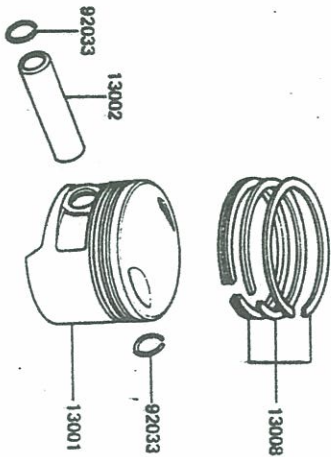





### 5. Valve

E1210-0016

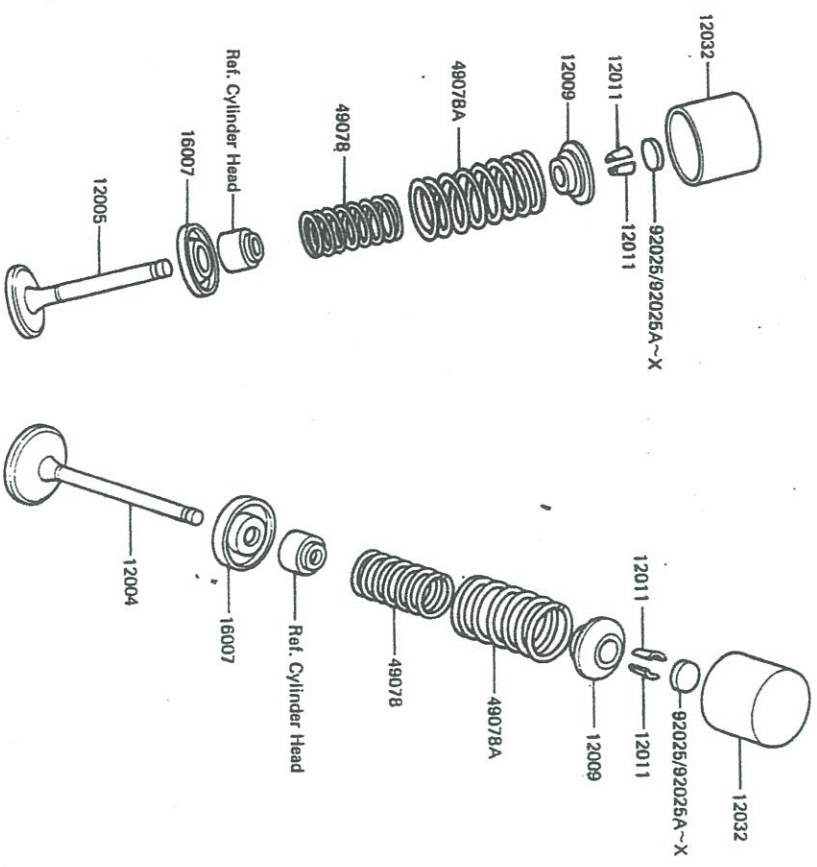

Ref. No.	Part No.	Description	Spec Code	Quantity - KZ1000	
				92	S1
12004	12004-1019	VALVE-IN TAKE		4	
	(RACING USE ONLY)				
12005	12005-1015	VALVE-EXHAUST		4	
	(RACING USE ONLY)				
12009	12009-1005	RETAINER-VALVE SPRING		8	
	(RACING USE ONLY)				
12011	12011-004	COLLET, RETAINER		16	
12032	12032-1003	TAPET		8	
	(RACING USE ONLY)				
16007	16007-1024	SEAT-SPRING, VALVE		8	
49078	49078-1007	SPRING-ENGINE VALVE, INNER		8	
	(RACING USE ONLY)				
49078A	49078-1008	SPRING-ENGINE VALVE, OUTER		8	
	(RACING USE ONLY)				
92025	92025-1090	SHIM, T=2.00		AR	
92025A	92025-1091	SHIM, T=2.05		AR	
92025B	92025-1092	SHIM, T=2.10		AR	
92025C	92025-1093	SHIM, T=2.15		AR	
92025D	92025-1094	SHIM, T=2.20		AR	
92025E	92025-1095	SHIM, T=2.25		AR	
92025F	92025-1096	SHIM, T=2.30		AR	
92025G	92025-1097	SHIM, T=2.35		AR	
92025H	92025-1098	SHIM, T=2.40		AR	
92025I	92025-1099	SHIM, T=2.45		AR	
92025J	92025-1100	SHIM, T=2.50		AR	
92025K	92025-1101	SHIM, T=2.55		AR	
92025L	92025-1102	SHIM, T=2.60, STD FOR KIT		AR	
92025M	92025-1103	SHIM, T=2.65		AR	
92025N	92025-1104	SHIM, T=2.70		AR	
92025O	92025-1105	SHIM, T=2.75		AR	
92025P	92025-1106	SHIM, T=2.80		AR	
92025Q	92025-1107	SHIM, T=2.85		AR	
92025R	92025-1108	SHIM, T=2.90		AR	
92025S	92025-1109	SHIM, T=2.95		AR	
92025T	92025-1110	SHIM, T=3.00		AR	
92025U	92025-1111	SHIM, T=3.05		AR	
92025V	92025-1112	SHIM, T=3.10		AR	
92025W	92025-1113	SHIM, T=3.15		AR	
92025X	92025-1114	SHIM, T=3.20		AR	

### 6. Camshaft, Tensioner

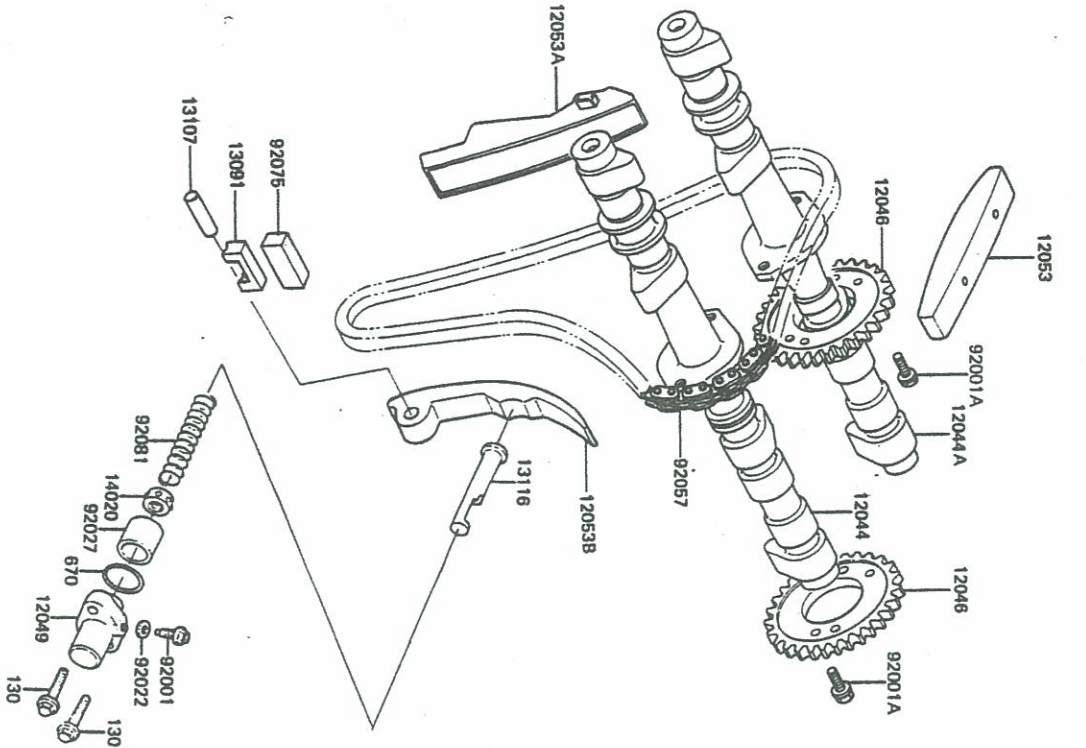

Ref. No.	Part No.	Description	Spec Code	Quantity
12044	12044-1047	CAMSHAFT-VALVE,IN (RACING USE ONLY)		1
12044A	12044-1048	CAMSHAFT-VALVE,EX (RACING USE ONLY)		1
12046	12046-1036	SPROCKET,CAMSHAFT,42T (RACING USE ONLY)		2
12049	12049-1008	TENSIONER,CAM CHAIN GUIDE-CHAIN,CAM,HEAD		1
12053	12053-1018	GUIDE-CHAIN,CAM,FR		1
12053A	12053-1048	GUIDE-CHAIN,CAM,RR		1
12053B	12053-1049	HOLDER,CAM CHAIN GUIDE		1
13091	13091-1084	SHAFT,8X28		1
13107	13107-1020	ROD-PUSH,CAM CHAIN		1
13116	13116-1019	RETAINER,TENSIONER		1
14020	14020-1002	BOLT,FLANGED,6X11		6
92001	92001-1155	WASHER,6,1X12X1		1
92001A	92003-208	COLLAR,TENSIONER		1
92022	92022-077	CHAIN,CAMSHAFT,79-01DX152L (RACING USE ONLY)		1
92027	92027-1273	DAMPER,CAM CHAIN GUIDE		1
92057	92057-1109	SPRING,TENSIONER		1
92075	92075-1270	BOLT-FLANGED,6X25		2
92081	92081-1380	O RING,21MM		1
130	130G0625			1
670	670B2021			1



E1321-0035

**7. Crankshaft**

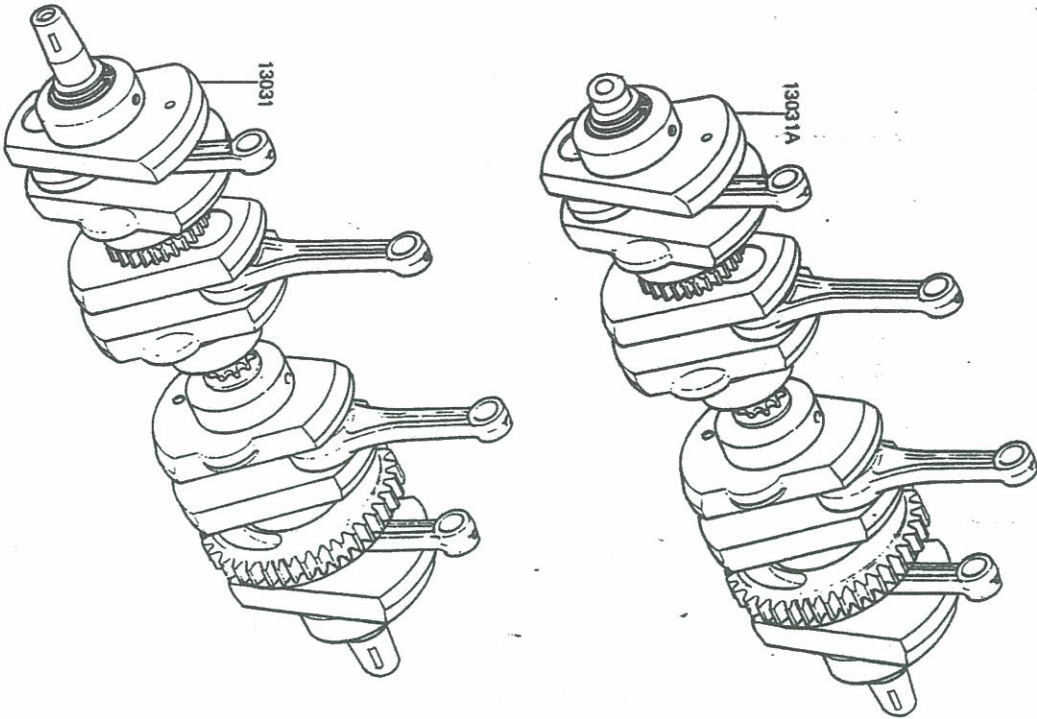

Ref. No.	Part No.	Description	Spec Code	Quantity - KZ1000
13031	13031-1073	CRANKSHAFT-COMP, ONLY FOR KIT (RACING USE ONLY)		1
13031A	13031-1078	CRANKSHAFT-COMP (RACING USE ONLY)		1







**9. Transmission**

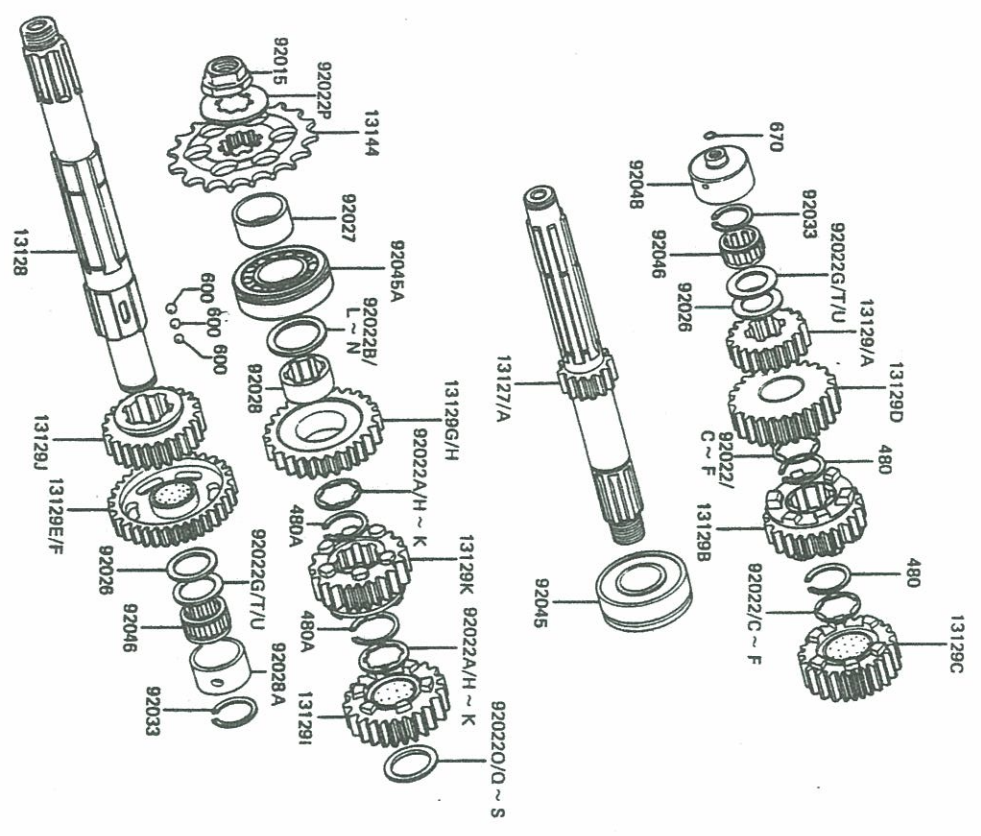

Ref. No.	Part No.	Description	Spec Code	QTY
13127	13127-1051	SHAFT-TRANSMISSION INPUT,16T (RACING USE ONLY)	AR	1
13127A	13127-1052	SHAFT-TRANSMISSION INPUT,15T (RACING USE ONLY)	AR	1
13128	13128-1041	SHAFT-TRANSMISSION OUTPUT (RACING USE ONLY)	AR	1
13129	13129-1326	GEAR,INPUT 2ND,20T (RACING USE ONLY)	AR	1
13129A	13129-1327	GEAR,INPUT 2ND,18T (RACING USE ONLY)	AR	1
13129B	13129-1328	GEAR,INPUT 3RD,22T (RACING USE ONLY)	AR	1
13129C	13129-1329	GEAR,INPUT 4TH,21T (RACING USE ONLY)	AR	1
13129D	13129-1330	GEAR,INPUT TOP,23T (RACING USE ONLY)	AR	1
13129E	13129-1331	GEAR,OUTPUT LOW,40T (RACING USE ONLY)	AR	1
13129F	13129-1332	GEAR,OUTPUT LOW,36T (RACING USE ONLY)	AR	1
13129G	13129-1333	GEAR,OUTPUT 2ND,37T (RACING USE ONLY)	AR	1
13129H	13129-1334	GEAR,OUTPUT 2ND,32T (RACING USE ONLY)	AR	1
13129I	13129-1335	GEAR,OUTPUT 3RD,34T (RACING USE ONLY)	AR	1
13129J	13129-1336	GEAR,OUTPUT 4TH,29T (RACING USE ONLY)	AR	1
13129K	13129-1337	GEAR,OUTPUT TOP,29T (RACING USE ONLY)	AR	1
13144	13144-1042	SPROCKET-OUTPUT,15T	AR	1
92015	92015-1210	NUT,20MM	AR	1
92022	92022-1077	WASHER,TOOTHED,26X35,5X1,5 (RACING USE ONLY)	AR	2
92022A	92022-1218	WASHER,TOOTHED,30X42X1,4	AR	2
92022B	92022-1219	WASHER,28,3X42X2,9	AR	1
92022C	92022-1322	WASHER,TOOTHED,26X35,5X1,1 (RACING USE ONLY)	AR	1
92022D	92022-1323	WASHER,TOOTHED,26X35,5X1,3 (RACING USE ONLY)	AR	1
92022E	92022-1324	WASHER,TOOTHED,26X35,5X1,6 (RACING USE ONLY)	AR	1
92022F	92022-1325	WASHER,TOOTHED,26X35,5X1,8 (RACING USE ONLY)	AR	1



### 9-1. Transmission

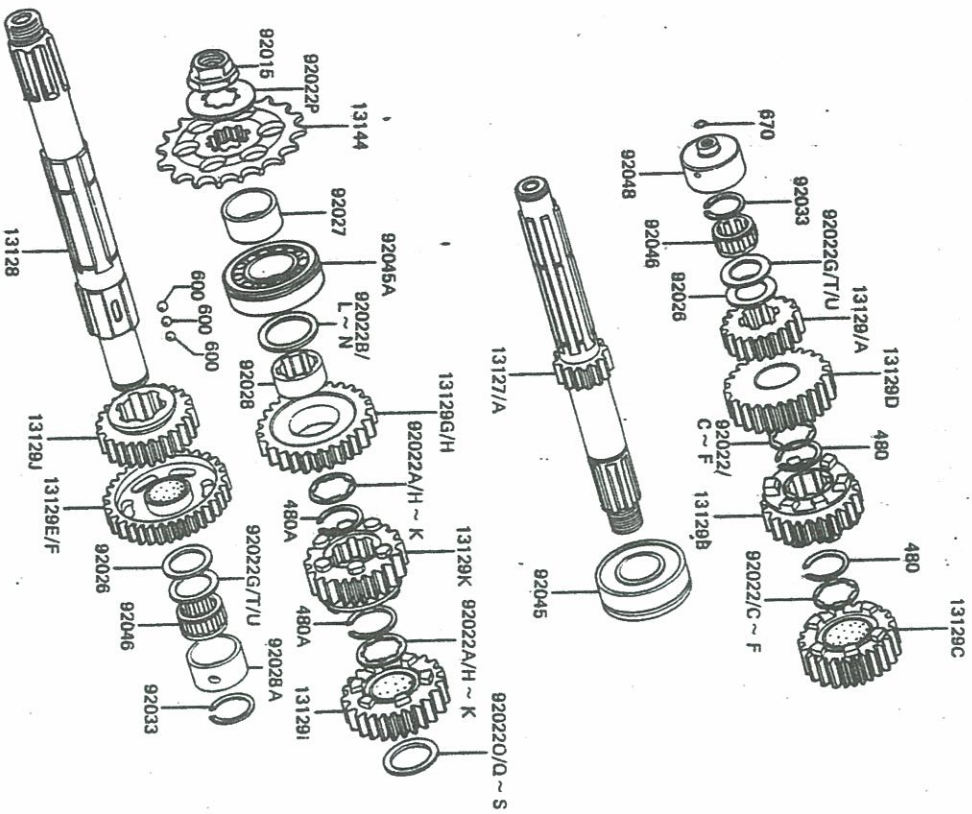

Ref. No.	Part No.	Description	Spec Code	Quantity	Unit
	92022G	92022-1326 WASHER, 28, 3X42X1.4	AR	1	
	92022H	92022-1327 WASHER, T00THED, 30X42X1.1	AR	1	
	92022I	92022-1328 WASHER, T00THED, 30X42X1.3	AR	1	
	92022J	92022-1330 WASHER, T00THED, 30X42X1.6	AR	1	
	92022K	92022-1331 WASHER, T00RHED, 30X42X1.8	AR	1	
	92022L	92022-1332 WASHER, 28, 3X42X2.7	AR	1	
	92022M	92022-1333 WASHER, 28, 3X42X3.1	AR	1	
	92022N	92022-1334 WASHER, 28, 3X42X3.2	AR	1	
	92022O	92022-1335 WASHER, 32, 3X42X2.8	AR	1	
	92022P	92022-1336 WASHER, T00THED, 23, 9X45X1.0	AR	1	
	92022Q	92022-1338 WASHER, 32, 3X42X3.0	AR	1	
	92022R	92022-1339 WASHER, 32, 3X42X3.2	AR	1	
	92022S	92022-1340 WASHER, 32, 3X42X3.4	AR	1	
	92022T	92022-212 WASHER, 22, 3X35X1.6	AR	2	
	92022U	92022-213 WASHER, 22, 3X35X1.2	AR	2	
	92026	92026-1020 SPACER, 22X35, 5X1.0	AR	2	
	92027	92027-1455 COLLAR, 29X40X25	AR	1	
	92028	92028-1155 BUSHING, 2ND GEAR	AR	1	
	92028A	92028-1155 BUSHING, OUTPUT SHAFT	AR	1	
	92033	92033-025 RING-SNAP, 22MM	AR	2	
	92045	92045-1028 BEARING-BALL, 5305NSH2	AR	1	
	92045A	92045-1034 BEARING-BALL, 63/28NC3	AR	1	
	92046	92046-031 BEARING-NEEDLE, FHF-223014	AR	2	
	92048	92048-1023 RACE, DRIVE SHAFT BEARING	AR	1	
	480	480J2800 CIRCRIP-TYPE-C, 28MM	AR	2	
	480A	480J3200 CIRCRIP-TYPE-C, 32MM	AR	2	



**9-2. Transmission**

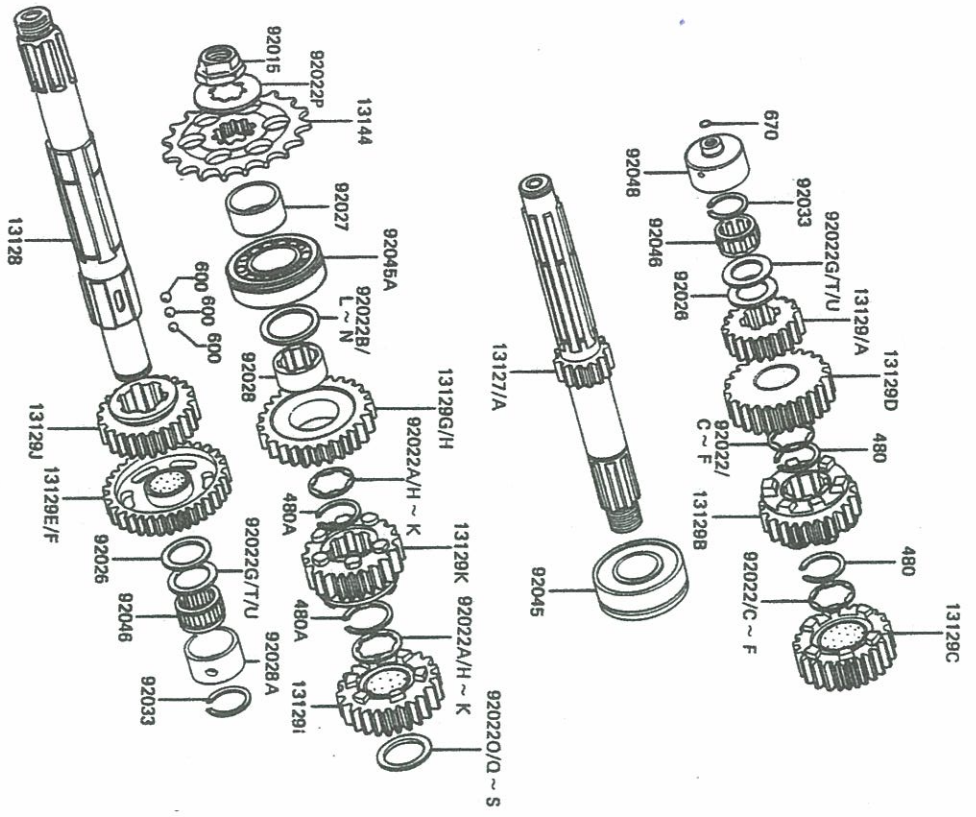

Ref. No.	Part No.	Description	Spec Code	Quantity
600	600A0600	BALL-STEEL, 3/16"		3
670	670B1508	O RING, 8MM		1



E1362-0009

### 10. Change Drum, Shift Fork

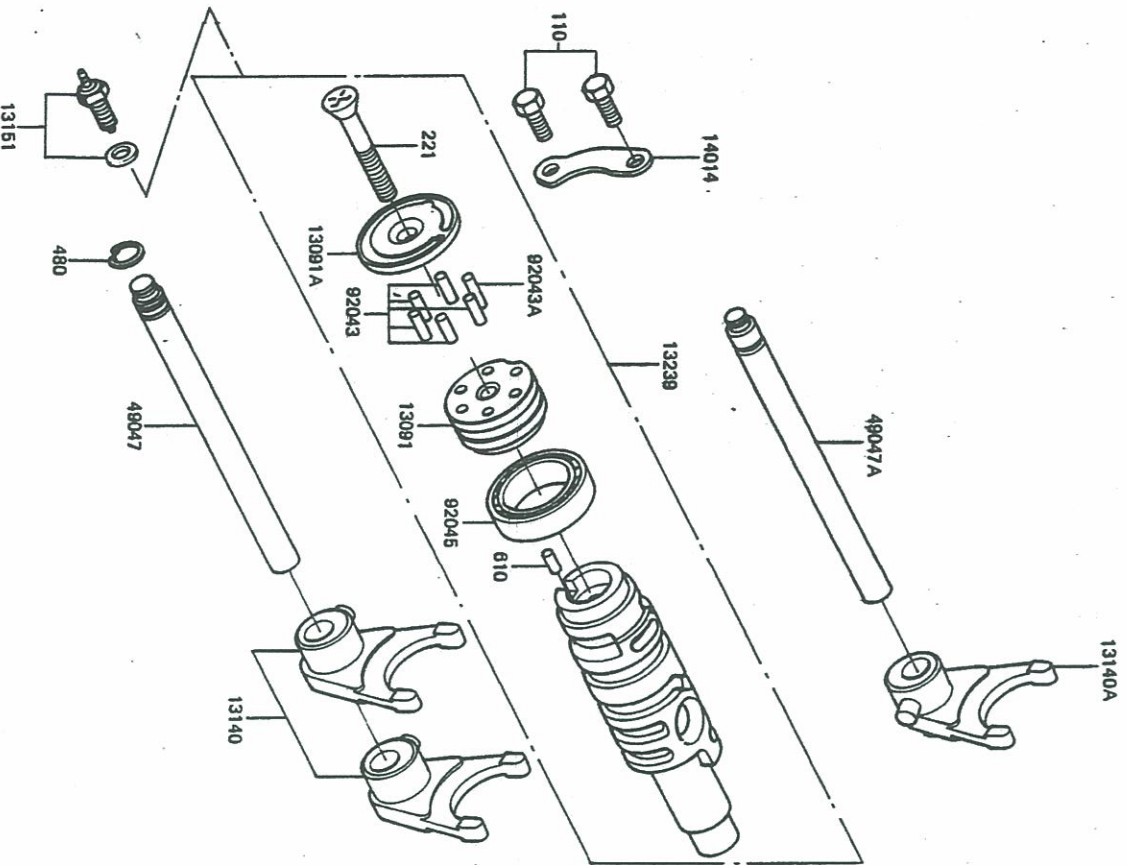

Ref. No.	Part No.	Description	Spec Code	Quantity - KZ199
13091	13091-1087	HOLDER/CHANGE DRUM PIN		1
13091A	13091-1088	HOLDER/CHANGE DRUM PIN		1
13140	13140-1045	FORK-SHIFT		2
13140A	13140-1046	FORK-SHIFT		1
13151	13151-5003	SWITCH-COMP		1
13239	13239-1060	DRUM-ASSY-CHANGE		1
14014	14014-1015	USE ONLY)		1
49047	49047-1013	PLATE-POSITION		1
49047A	49047-1014	ROD-SHIFT		1
92043	92042-014	ROD-SHIFT		1
		PIN/DOWEL, 4X15.8		5
92043A	92042-020	DRUM-ASSY-CHANGE		1
92045	92045-1035	USE ONLY)		1
110	110G0616	PIN/DOWEL, 4X17.8		1
221	221B0545	BEARING-BALL, 6806		1
480	480J1200	BOLT, 6X16		2
		SCREW-CSK-CROS, 6X45		1
610	610A0410	CIRCRIP-TYPE-C, 12MM		1
		ROLLER, 4X10		1



**11. Gear Change Mechanism**

E1 482

Ref. No.	Part No.	Description	Spec Code	Quan.	KZ1000
				82	
				S1	

13161	13161-1023	LEVER-COMP-CHANGE SHAFT		1	
13168	13168-1074	LEVER,GEAR POSITIONING		1	
13236	13236-1029	LEVER-COMP,NEUTRAL POSITIONING		1	
92001	92001-1401	BOLT,RETURN SPRING		1	
92081	92081-1284	SPRING,POSITIONING LEVER		1	
92081A	92081-1285	SPRING,NEUTRAL POSITIONING		1	
92081B	92083-018	SPRING,CHANGE PEDAL RETURN		1	
92081C	92083-028	SPRING,CHANGE PEDAL RETURN		1	
482	482J6000	CIRCRIP-TYPE-E,6MM		2	

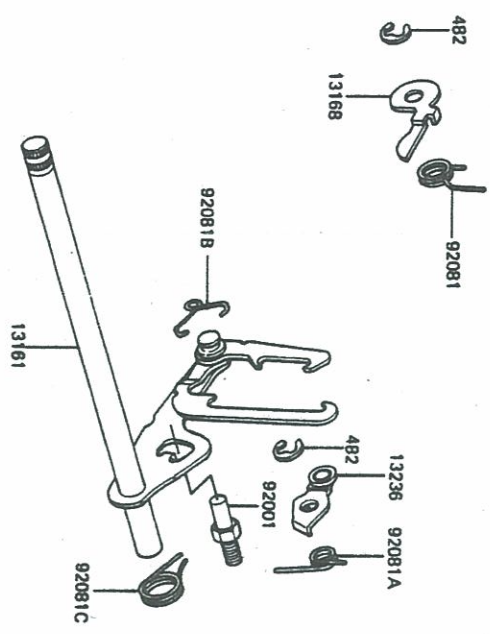



E1411-0052

## 12. Crankcase

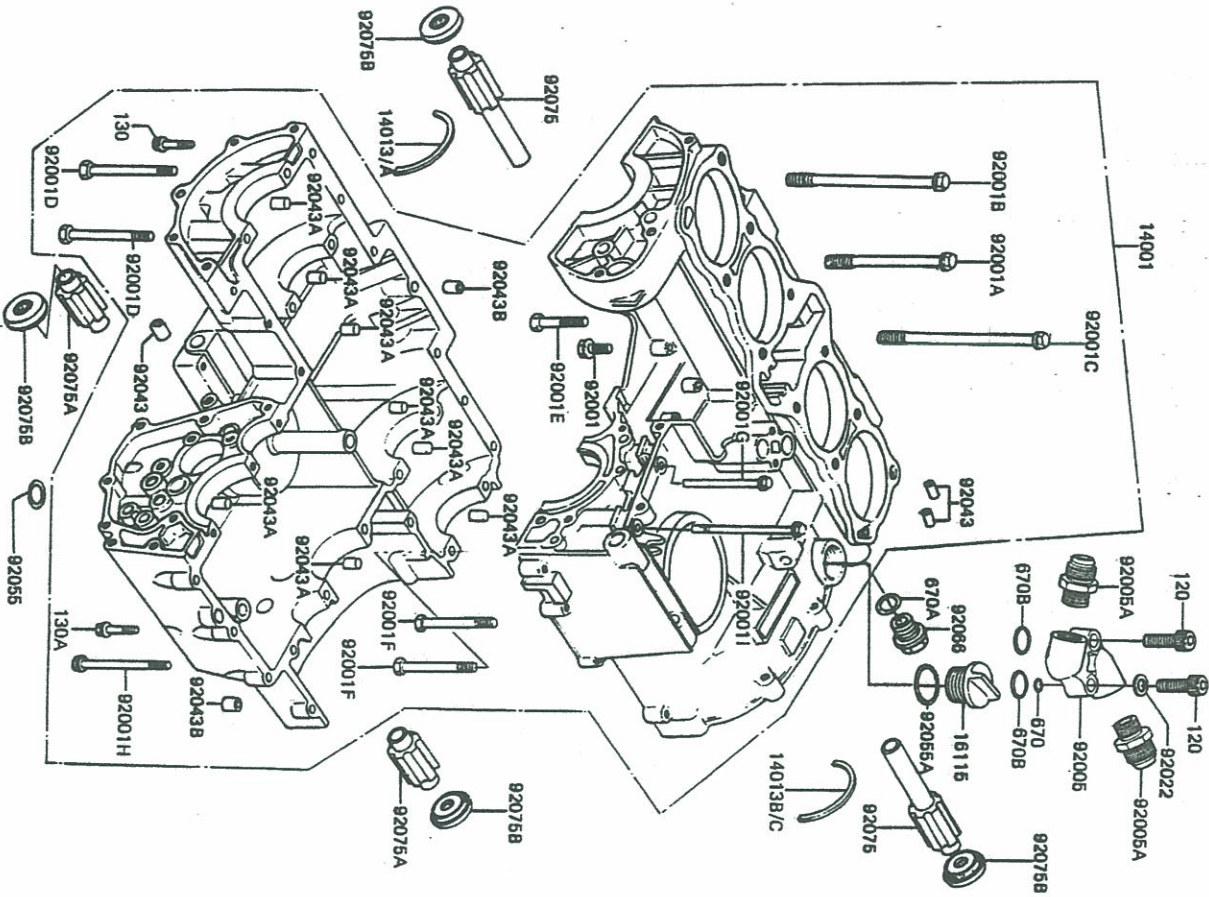

Ref. No.	Part No.	Description	Spec Code	Quantity - LTR
				82
				S1

14001	14001-5119	SET-CRANKCASE, BLACK (RACING USE ONLY)		1
14013	14013-013	RING-POSITION		1
14013A	14013-1004	RING-POSITION		1
14013B	14013-1005	RING-POSITION		1
14013C	14013-1006	RING-POSITION		1
16115	16115-013	CAP-OIL FILLER		1
92001	92001-1349	BOLT, FLANGED, 8X16		1
92001A	92001-1661	BOLT, FLANGED, 10X152 (RACING USE ONLY)		4
92001B	92001-1662	BOLT, FLANGED, 10X172 (RACING USE ONLY)		4
92001C	92001-1663	BOLT, FLANGED, 10X187 (RACING USE ONLY)		4
92001D	92003-106	BOLT, 8X95		2
92001E	92003-107	BOLT, 8X72		2
92001F	92003-108	BOLT, HEX HEAD, 8X81		2
92001G	92003-111	BOLT, FLANGED, 6X99		1
92001H	92003-112	BOLT, FLANGED, 6X94		3
92001I	92003-113	BOLT, FLANGED, 6X116		1
92005	92003-1052	FITTING, OIL TUBE (RACING USE ONLY)		1
92005A	92005-1053	FITTING, NIPPLE, M16U3/4 (RACING USE ONLY)		2
92022	92022-1086	WASHER, 8, 2X16X1		1
92043	92042-007	PIN, DOWEL, 6, 3X8X14		6
92043A	92042-016	PIN, DOWEL, 6X16		8
92043B	92043-1037	PIN, DOWEL, 10X14		4
92055	92055-048	RING-0, 0D=18		1
92055A	92055-049	RING-0, 31MM		1
92066	92066-021	PLUG, 14X12		1
92075	92075-1272	DAMPER, ENGINE MOUNT, UPP		2
92075A	92075-1273	DAMPER, ENGINE MOUNT, LWR		2
92075B	92075-1274	DAMPER, ENGINE MOUNT, SIDE		4
120	120P0825	BOLT-SOCKET, 8X25		4
130	130G0640	BOLT-FLANGED, 6X40		3
130A	130G0655	BOLT-FLANGED, 6X55		2
670	670B1509	O RING, 9MM		1
670A	670B2015	O RING, 15MM		1
670B	670B2018	O RING, 18MM		2



**13. Crankcase Bolt Pattern**

E14120014

Ref. No.	Part No.	Description	Spec Code
92001	92003-112	BOLT, FLANGED, 6X9.4	1
130	130G0640	BOLT-FLANGED, 6X4.0	9
130A	130G0650	BOLT-FLANGED, 6X5.0	1

Quantity-K	82	81
1		
9		
1		

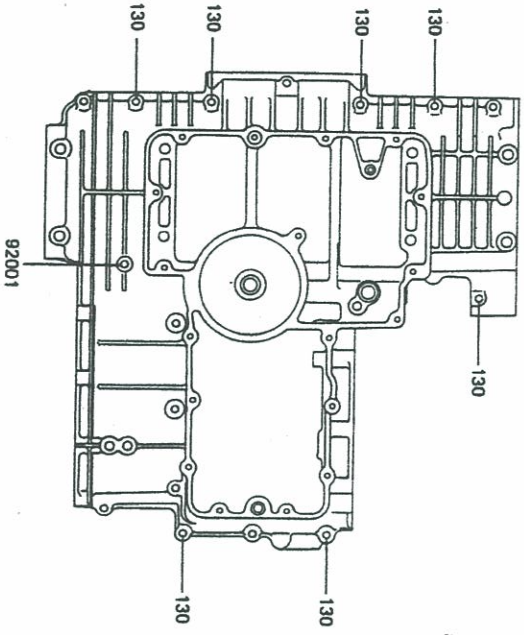
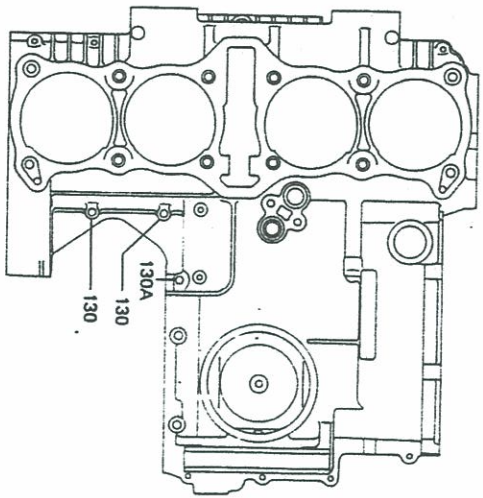



E1431-0081

### 14. Engine Cover

Ref. No.	Part No.	Description	Spec Code	Quantity
				72
				81

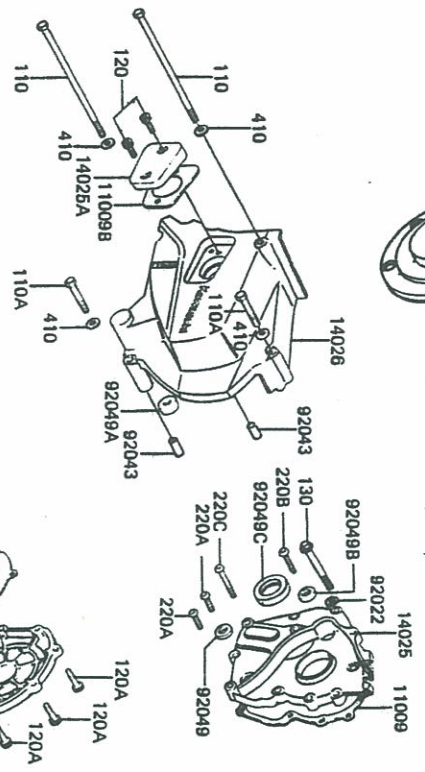
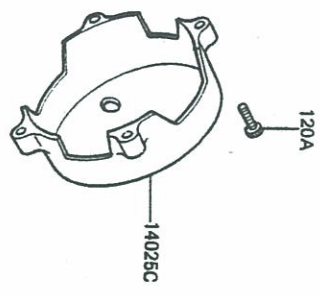
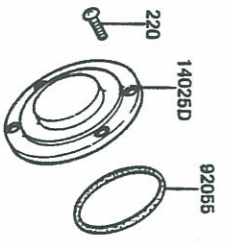
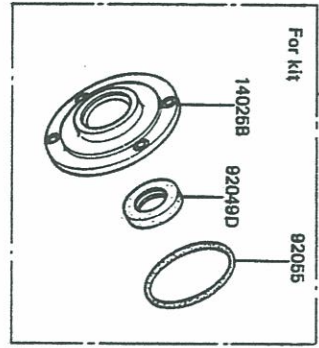

11009	11009-1163	GASKET,MISSION COVER		1
11009A	11009-1210	GASKET,CLUTCH COVER		1
11009B	11009-1211	GASKET,CLUTCH ADJUSTING COVER		1
14025	14025-1240	COVER,TRANSMISSION		1
14025A	14025-1249	COVER,CLUTCH RELEASES		1
14025B	14025-1499	COVER,CRANK LEFT,ONLY FOR KIT		1
14025C	14025-1500	COVER,CD1 ROTOR		1
14025D	14025-1543	COVER,CRANK LFFT		1
14026	14026-1063	COVER-CHAIN		1
14032	14032-1047	COVER-CLUTCH		1
52005	52005-1009	GAUGE,OIL LEVEL		1
92022	92022-077	WASHER,6,1X12X1		1
92043	92042-007	PIN,DOWNEL,6,5X8X14		2
92049	92049-004	SEAL-OIL,SB12205		1
92049A	92049-1003	SEAL-OIL,CLUTCH RELEASE		1
92049B	92049-1017	SEAL-OIL,SD-8187		1
92049C	92049-1070	SEAL-OIL,AE2343FD		1
92049D	92049-1094	SEAL-OIL,25X38X7,ONLY FOR KIT		1
92055	92055-1139	RING-O,1D=61,6		1
110	110606125	BOLT,6X125		2
110A	11060670	BOLT,6X70		2
120	120P0614	BOLT-SOCKET,6X14		2
120A	120P0625	BOLT-SOCKET,6X25		13
130	130G0655	BOLT-FLANGED,6X55		1
220	220B0512A	SCREW-PAN-CROS,5X12		4
220A	220B0620	SCREW-PAN-CROS,6X20		6
220B	220B0628	SCREW-PAN-CROS,6X28		2
220C	220B0640	SCREW-PAN-CROS,6X40		2
410	410B06500	WASHER-PLANE-SMALL,6MM		4



**15. Engine Cover "A"**

E1432-0010

Ref. No.	Part No.	Description	Spec Code	Quantity
				92
				S1

11009	16112-002	GASKET,OIL PAN		1
11009A	92065-097	GASKET,DRAIN PLUG		1
14070	14070-006	BODY-BREATHER		1
49034	49034-5014	PAN-OIL		1
92001	92003-107	BOLT,8X72		1
92055	92055-052	RING-O,91MM		2
92066	92066-053	PLUG,OIL DRAIN,12X15		1
130	130G0625	BOLT-FLANGED,6X25		13
130A	130G0635	BOLT-FLANGED,6X35		3
130B	130G0645	BOLT-FLANGED,6X45		1
670	670B1508	O RING,8MM		1

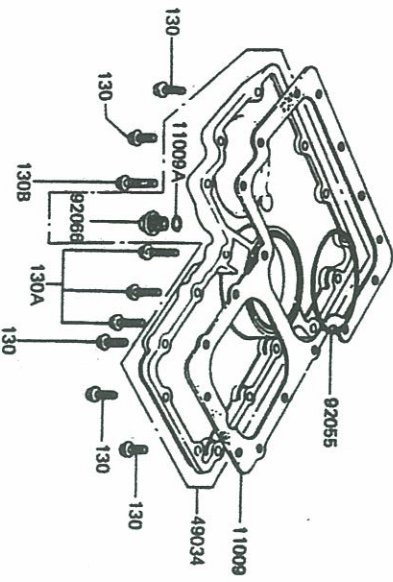
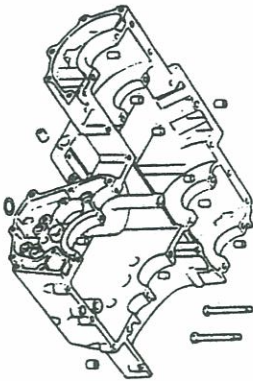
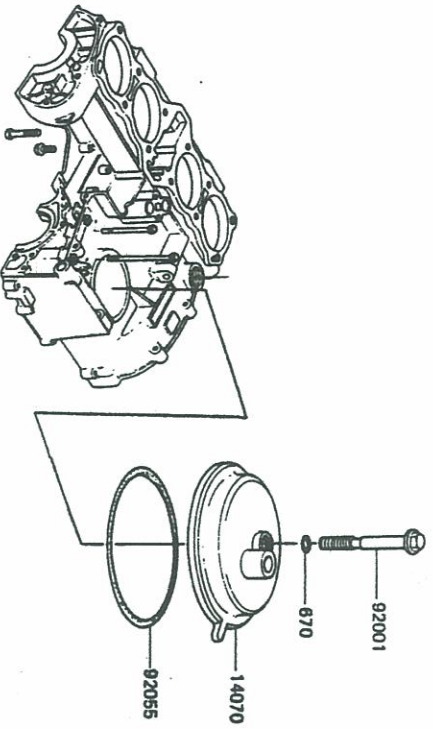



# 16. Oil Pump

92065

E1710-0025

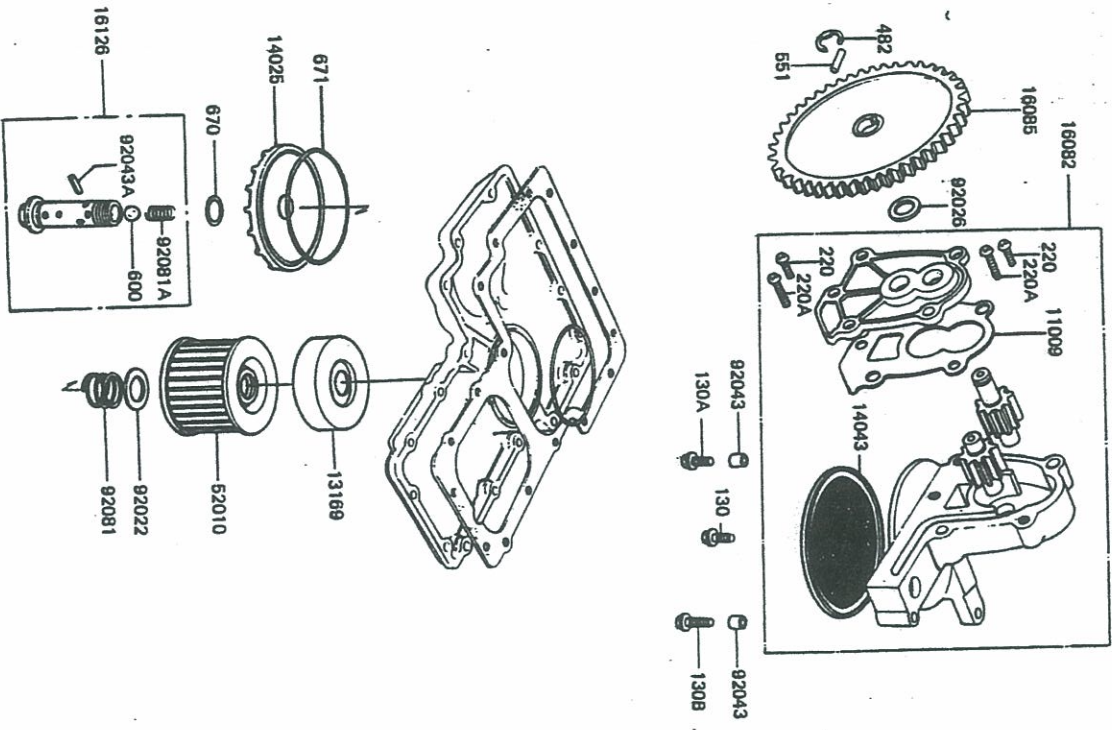

Ref. No.	Part No.	Description	Spec Code
----------	----------	-------------	-----------

11009	11009-1029	GASKET/OIL PUMP	
13169	13169-1313	PLATE/OIL FILTER	
14025	16101-004	COVER/OIL FILTER	
14043	16111-004	FILTER/OIL PUMP	
16082	16082-059	PUMP-ASSY-OIL	
16085	16085-019	GEAR/OIL PUMP 49T	
16126	16126-1001	VALVE/OIL FILTER	
52010	16099-003	ELEMENT-OIL FILTER	
92022	92022-1012	WASHER,20,5X30X1	
92026	92026-080	SPACER,10X18X1,0	
92043	92042-038	PIN/DOWEL,8X10	
92043A	92043-111	PIN/SPRING,2X20	
92055	92055-048	RING-O,OD=18	
92081	92081-1018	SPRING/OIL FILTER	
92081A	92081-109	SPRING	
130	130G0625	BOLT-FLANGED,6X25	
130A	130G0635	BOLT-FLANGED,6X35	
130B	130G0645	BOLT-FLANGED,6X45	
220	220B0618	SCREW-PAN-CROS,6X18	
220A	220B0628	SCREW-PAN-CROS,6X28	
482	482K7000	CIRCRIP-TYPE-E,7MM	
551	551A0314	PIN-DOWEL,3X14	
600	600A1200	BALL-STEEL,3/8"	
670	670B2016	O RING,16MM	
671	671B2590	O RING,90MM	

Quantity	Unit
32	
51	



**17. Generator**

E1810-0059

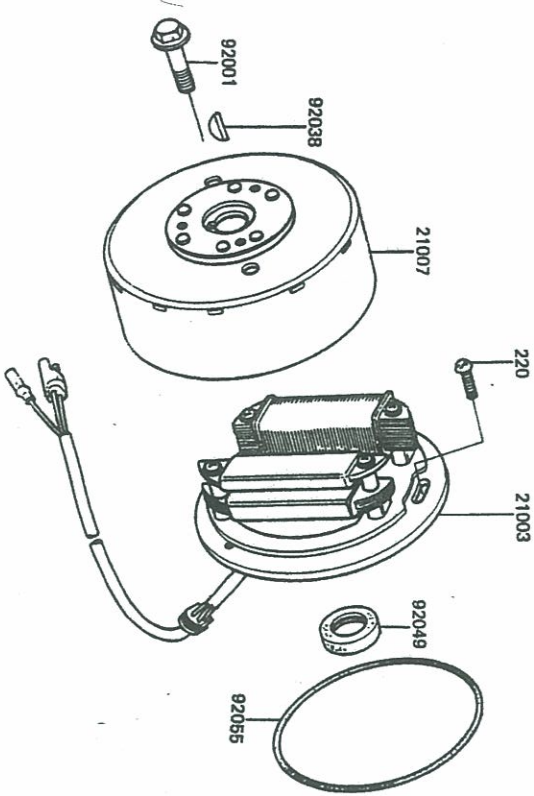

Ref. No.	Part No.	Description	Spec Code	Quantity - KZ1000
21003	21003-1065	STATOR (RACING USE ONLY)		1
21007	21007-1053	ROTOR (RACING USE ONLY)		1
92001	92001-1679	BOLT, FLANGED, 12X25 (RACING USE ONLY)		1
92038	92038-1003	KEY, T=4 (RACING USE ONLY)		1
92049	92049-1094	SEAL-OIL, 25X38X7, ONLY FOR KIT (RACING USE ONLY)		1
92055	92055-1139	RING-O, ID=61.6 (RACING USE ONLY)		1
220	220B0512A	SCREW-PAN-CR05, 5X12		2

E1830-0117

**18. Ignition Coil**

Ref. No.	Part No.	Description	Spec Code	Quantity
21119	21119-1057	IGNITER (RACING USE ONLY)		1
21121	21121-1057	COIL-IGNITION (RACING USE ONLY)		4
21160	21160-1017	CAP-ASSY-PLUG LIMITER		8
39076	39076-1002	(RACING USE ONLY)		1
92027	92027-1469	COLLAR-12,2X17,5X5.5 (RACING USE ONLY)		4
92070	92070-1056	PLUG-SPARK, CHAMP A55G (RACING USE ONLY)		8
120	120P0616	BOLT-SOCKET, 6X16		4
411	411B0600	WASHER-PLANE, 6MM		4

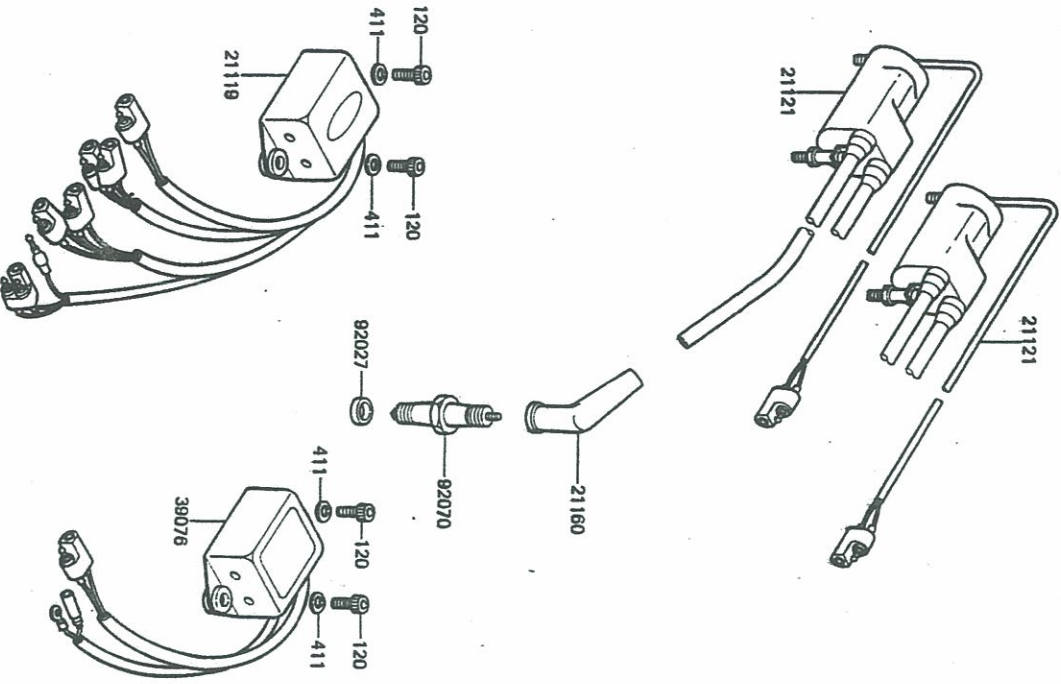



**19. Oil Cooler**

Ref. No.	Part No.	Description	Spec Code	Quantity
				02
				S1

39061	39061-1009	O. COOLER, WIL-QUIP, HA-SC-13-10 (RACING USE ONLY)	1
51044	51044-1022	TUBE-ASSY, OIL COOLER, L=550, LH (RACING USE ONLY)	1
51044A	51044-1023	TUBE-ASSY, OIL COOLER, L=600, RH (RACING USE ONLY)	1

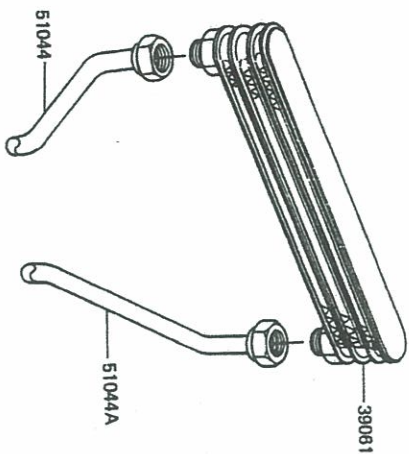

**20. Tool**

F2810-0079

Ref. No. Part No. Description Spec Code

57001	57001-1016	PULLER, DYNAMO ROTOR	1016
57001A	57001-1024	WRENCH, SPARK PLUG, N/O FOR KIT	1024
57001B	57001-1166	BASE-PISTON, D=6MM	1166
57001C	57001-1167	GUIDE-OIL SEAL, D=10MM	1167
57001D	57001-1168	ADAPTER-MAGNETO PULLER	1168
57001E	57001-1169	BOLT-MAGNETO PULLER	1169
57001F	57001-259	PULLER, MAGNETO	259
57001G	57001-306	HOLDER, ENG. SPROCKET	306

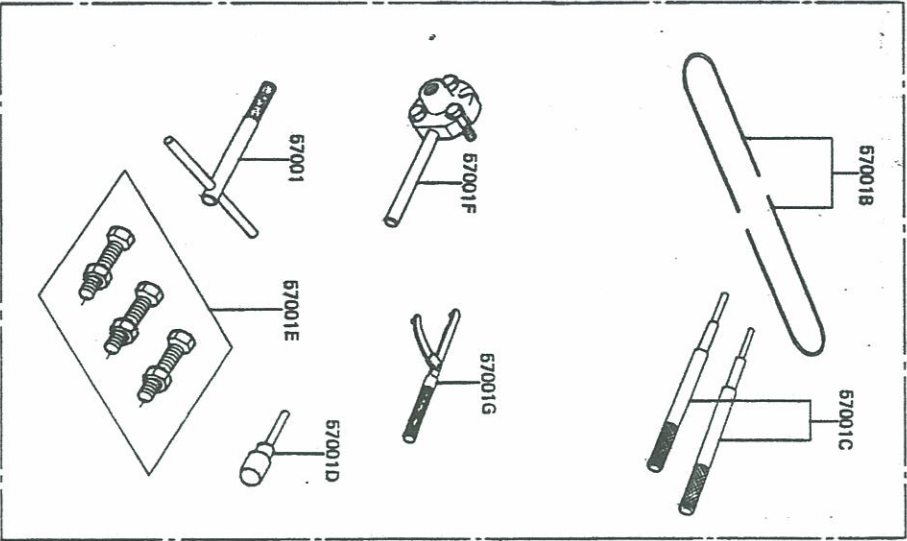

For FULL KIT

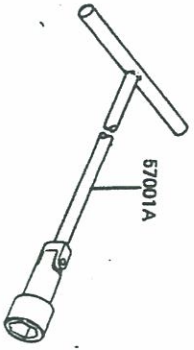



# Numerical Parts Index

Part No.	Fig. No.	Part No.	Fig. No.	Part No.	Fig. No.	Part No.	Fig. No.	Part No.	Fig. No.	Part No.	Fig. No.	Part No.	Fig. No.
110606125	14	13049-1007	8	14013-1005	12	49002-1019	1	92003-208	6	92025-1102	5	92025-1102	5
11060616	10	13081-1063	8	14013-1006	12	49003-5014	15	92003-228	1	92025-1103	5	92025-1103	5
11060670	14	13087-1009	8	14014-1015	10	49047-1013	10	92004-1043	1	92025-1104	5	92025-1104	5
11004-1040	3	13088-1013	8	14020-1002	8	49078-1014	10	92005-1052	12	92025-1105	5	92025-1105	5
11008-1118	3	13089-1004	8	14020-1016	8	49078-1007	5	92005-1053	12	92025-1106	5	92025-1106	5
11008-1049	1	13091-1008	2	14025-1249	14	49078-1008	5	92009-1009	8	92025-1107	5	92025-1107	5
11009-1029	16	13091-1009	2	14025-1249	14	51044-1022	19	92015-1053	8	92025-1108	5	92025-1108	5
11009-1163	14	13091-1041	8	14025-1464	2	51044-1023	19	92015-1210	9	92025-1109	5	92025-1109	5
11009-1205	2	13091-1042	8	14025-1499	14	52005-1009	14	92022-077	6	92025-1110	5	92025-1110	5
11009-1207	3	13091-1043	8	14025-1500	14	55001615	8	92022-077	6	92025-1111	5	92025-1111	5
11009-1208	3	13091-1084	6	14025-1543	14	551A0314	16	92022-1005	1	92025-1112	5	92025-1112	5
11009-1210	14	13091-1085	8	14026-1063	14	57001-1016	20	92022-1012	16	92025-1113	5	92025-1113	5
11009-1211	14	13091-1087	10	14032-1047	14	57001-1021	20	92022-1077	9	92025-1114	5	92025-1114	5
120P0614	14	13091-1088	10	14070-1024	15	57001-1166	20	92022-1086	12	92026-080	16	92026-080	16
120P0614	2	13091-1089	8	16007-1024	1	57001-1167	20	92022-1114	8	92026-1020	8	92026-1020	8
120P0614	18	13102-1012	8	16065-1036	1	57001-1168	20	92032-1218	9	92026-1043	8	92026-1043	8
120P0625	16	13107-1020	8	16082-059	16	57001-1169	20	92032-1219	9	92027-1273	6	92027-1273	6
120P0825	12	13107-1024	8	16085-019	16	57001-259	20	92032-1221	8	92027-1284	8	92027-1284	8
120Q0616	8	13116-1019	6	16099-003	16	57001-306	20	92032-1223	8	92027-1455	9-1	92027-1455	9-1
120S0616	1	13116-1039	6	16101-004	16	600A0600	9-2	92032-1322	9	92027-1466	18	92027-1466	18
12004-1019	5	13119-1003	8	16111-004	16	600A1200	16	92022-1323	9	92028-1155	9-1	92028-1155	9-1
12005-1015	5	13127-1051	9	16112-002	15	601B6601	8	92022-1324	9	92028-123	9-1	92028-123	9-1
12009-1005	5	13127-1052	9	16115-013	12	610A0410	10	92032-1325	9	92033-025	9-1	92033-025	9-1
12011-004	5	13128-1041	9	16126-1001	16	670B1508	15	92032-1326	9	92033-1029	8	92033-1029	8
12032-1003	5	13128-1324	9	21003-1063	17	670B1508	9-2	92032-1327	9-1	92033-1054	4	92033-1054	4
12044-1047	6	13129-1327	9	21007-1053	17	670B1509	12	92032-1328	9-1	92036-023	1	92036-023	1
12044-1048	6	13129-1328	9	21119-1057	18	670B2015	12	92032-1328	9-1	92037-201	1	92037-201	1
12046-1036	6	13129-1329	9	21121-1067	18	670B2016	16	92032-1330	9-1	92038-1003	17	92038-1003	17
12049-1008	6	13129-1350	9	21600-1017	18	670B2018	12	92032-1331	9-1	92042-007	1	92042-007	1
12053-1018	6	13129-1351	9	22080512A	17	670B2021	6	92032-1333	9-1	92042-007	14	92042-007	14
12053-1048	6	13129-1332	9	22080512A	14	670D1510	2	92032-1334	9-1	92042-007	12	92042-007	12
12053-1049	6	13129-1333	9	22080618	16	671B2590	16	92032-1335	9-1	92042-014	10	92042-014	10
13060625	16	13129-1334	9	22080620	16	92001-1155	6	92032-1336	9-1	92042-016	12	92042-016	12
13060625	15	13129-1335	9	22080628	14	92001-1350	12	92032-1338	9-1	92042-020	10	92042-020	10
13060625	6	13129-1336	9	22080628	14	92001-1350	2	92032-1339	9-1	92042-028	3	92042-028	3
13060625	15	13129-1337	9	22080640	14	92001-1350	2	92032-1340	9-1	92042-038	16	92042-038	16
13060635	16	13140-1045	10	22180645	10	92001-1401	11	92032-212	9-1	92043-1037	3	92043-1037	3
13060640	13	13140-1046	10	31880800	8	92001-1661	12	92032-213	9-1	92043-1037	12	92043-1037	12
13060640	12	13144-1002	9	39061-1002	19	92001-1662	12	92035-1090	5	92043-111	16	92043-111	16
13060645	16	13151-5003	10	39076-1009	18	92001-1665	12	92035-1091	5	92043-1001	8	92043-1001	8
13060645	15	13161-1023	11	410B0600	14	92001-1679	17	92035-1092	5	92045-1028	9-1	92045-1028	9-1
13060650	13	13168-1074	11	41180600	18	92003-092	1	92035-1093	5	92045-1034	9-1	92045-1034	9-1
13060655	12	13169-1313	16	4181000	1	92003-106	12	92035-1094	5	92045-1035	10	92045-1035	10
13060655	14	13187-1004	8	48011200	10	92003-107	12	92035-1095	5	92046-031	9-1	92046-031	9-1
13001-1087	4	13223-011	2	480J2800	9-1	92003-107	12	92035-1096	5	92048-1023	9-1	92048-1023	9-1
13002-1013	4	13236-1029	11	480J3200	9-1	92003-108	12	92035-1097	5	92049-004	14	92049-004	14
13008-5048	4	13239-1060	10	481J5000	8	92003-111	12	92035-1098	5	92049-016	1	92049-016	1
13031-1073	7	14001-5119	12	482J6000	11	92003-112	12	92035-1099	5	92049-1003	14	92049-1003	14
13031-1078	7	14013-015	12	482K7000	16	92003-112	13	92035-1100	5	92049-1017	14	92049-1017	14
13034-030	1	14013-1004	12	49002-1018	1	92003-113	12	92035-1101	5	92049-1070	14	92049-1070	14



